

The 9th International Attachment Conference

July 18th – 20th, 2019

Vancouver, Canada

The Society for Emotion & Attachment Studies

SFU

SIMON FRASER UNIVERSITY
ENGAGING THE WORLD

Letters of Welcome

Dear colleagues,

It gives me enormous pleasure to welcome you on behalf of the Society for Emotion and Attachment Studies to the 2019 International Attachment Conference in the great city of Vancouver. As you will see, the program has an extraordinary wealth of keynote lectures, symposia and poster sessions, showcasing just how vibrant our field is, from basic research to prevention, treatment and community practice. The conference, I know, will be a wonderful opportunity to meet old colleagues and new, learn about the latest science and practice in field of attachment, generate new ideas and collaborations and enjoy some of Vancouver's rich cultural life. Here's to a great conference!

Yours,

Pasco Fearon, President, SEAS

We are so very pleased to welcome each of you to this exciting conference. We acknowledge and give thanks for the privilege of meeting in Vancouver on the unceded lands of the Coast Salish peoples, including the territories of the Musqueam, Squamish, Kwikwetlem and Tsleil-Waututh Nations. We are also grateful to all of our inspired speakers and exceptional presenters who have worked hard to bring you cutting edge research and innovative clinical applications. Join us in celebrating remarkable advances in this rich and inspiring field of work and enjoy the beauty and many gifts that Vancouver and British Columbia has to offer!

Warmly,

Marlene M. Moretti, 9th IAC Chairperson

Sponsors

IAC 2019 is sponsored by The Society for Emotion and Attachment Studies (SEAS), the International Attachment Network (IAN), Simon Fraser University (SFU), SFU Department of Psychology, and the Annie E. Casey Foundation.



THE ANNIE E. CASEY FOUNDATION

Acknowledgement

IAC 2019 respectfully acknowledges that SFU Harbour Centre is on the unceded ancestral and traditional territories of the sə́ililwə́taʔ (Tsleil-Waututh), Sk̓w̓x̓wú7mesh Úxwumixw (Squamish), xʷməθkʷəy̓əm (Musqueam) and kʷikʷə́l̓əm (Kwkwetlem) Nations.

Special Thanks

IAC 2019 gives a special thanks to SEAS Executive Board Members, Local Organizing Committee members, SFU Department of Psychology, the Adolescent Health Lab, and volunteers for their immense support in this year's IAC.

SEAS Executive Board

Dr. Pasco Fearon, President

Dr. Howard Steele, Past President, USA

Dr. Marlene Moretti, Canada

Dr. Lavinia Barone, Vice-President and Treasurer, Italy

Dr. Carlo Schuengel, The Netherlands

Dr. Marian Bakermans-Kranenburg, The Netherlands

Dr. Mario Mikulincer, Israel

Local Organizing Committee

Dr. Sheri Madigan, University of Calgary

Dr. Tanya Broesch, Simon Fraser University

Dr. Yuthika Girme, Simon Fraser University

Dr. Sonya Vellet, Vellet & Associates

Dr. Catherine Costigan, University of Victoria

Dr. Veronica Kallos-Lilly, Vancouver Couple & Family Institute

Dr. Dave Pasalich, The Australian National University

Volunteers

Christine Church

Rajan Hayre

Julia Vernon

Katherine O'Donnell

Natalie Goulter

Lin Bao

Antonia Dangaltcheva

Mari del Casal

Emily Thornton

Sherene Balanji

Tim James

Keith Hamilton

Dana Cochrane

Nicole Muir

Richard Rigby

Matt Wakefield

Carlos Sierra Hernandez

Jason Chung

Table of contents

Information.....	5
IAC Pre-Conference Workshops.....	7
Day 1 Program Overview: Thursday, July 18 th	8
Day 2 Program Overview: Friday, July 19 th	9
Day 3 Program Overview: Saturday, July 20 th	10
Clinical Discussion Panels 1.....	11
Symposium Session 1.....	13
Poster Session 1.....	21
Symposium Session 2.....	23
Poster Session 2.....	31
Clinical Discussion Panels 2.....	33
Symposium Session 3.....	36
Poster Session 3.....	44
Symposium Session 4.....	46
Poster Session 4.....	53
Launch of new Special Interest Research Groups.....	55
Symposium Session 5.....	56
Poster Session 5.....	63
Symposium Session 6.....	65
Poster Session 6.....	71
SEAS Information & SEAS General Meeting.....	73
Conference Venue Map	74
Food & Shopping.....	75
Maps & Directions.....	76

Information

Conference Venue

Hyatt Regency Vancouver
655 Burrard Street, Vancouver,
British Columbia, V6C 2R7, Canada

Pre-Conference Workshop Venue

All pre-conference workshops will be held at Simon Fraser University (SFU) Harbour Centre which is a short 10-15 minute walk from the conference venue.

SFU Harbour Centre
515 W Hastings St,
Vancouver, BC V6B 5K3, Canada

Keynote Speakers

We are delighted to have an exceptional lineup of Keynote speakers. Each Keynote will occur in the morning from 9 am to 12:30 pm. No other sessions will overlap with Keynote presentations.

Thursday, July 18th

Dr. Marinus van IJzendoorn, Erasmus University Rotterdam, The Netherlands

Dr. Frans de Waal, Emory University, USA

Dr. Patricia K. Kerig, University of Utah, USA

Friday, July 19th

Dr. Carlo Schuengel, Vrije Universiteit Amsterdam, The Netherlands

Dr. Ross A. Thompson, University of California, Davis, USA

Dr. Sheri Madigan, University of Calgary, Canada

Saturday, July 20th

Dr. Marlene M. Moretti, Simon Fraser University, Canada

Dr. Howard Steele, New School for Social Research, New York, USA

Dr. Sue Johnson, University of Ottawa, Canada

For Keynote biographies and details on their talks, please visit
<http://internationalattachmentconference.com/keynote-speakers/>

Registration & Information Desk

Registration desk will be located in the Regency Foyer and will be staffed during the following times:

Thursday, July 18th – 7:30 am – 5:30 pm

Friday, July 19th – 8:00 am – 5:30 pm

Saturday, July 20th – 8:00 am – 10:00 am

Your name badge must be worn at all times. The venue will not have a dedicated coat room for coats, luggage, or poster tubes so please be mindful of your belongings.

AM/PM Refreshment Breaks

Coffee, tea, water, and refreshments will be available during scheduled break times and are included in the conference registration fee.

Lunch is not included in the registration fee; please see list of nearby restaurants in the back of the program. Starbucks is conveniently located on the main floor (1st floor) of the conference venue.

Welcome Reception

We invite all Delegates who purchased a ticket to join us on the Perspectives Level (top floor) of the Hyatt Regency for the Welcome Reception on Thursday, July 18th at 5:30 pm. Tickets for the reception will be distributed upon check-in at our registration desks and attached to your name badge.

WIFI

Wifi is available to delegates for the entirety of the conference. While in the main conference space, wifi can be accessed through the login below.

Connect to: Hyatt_Meetings

Login: attachment

Password: 2019

Free wifi is also provided on main floor (1st floor), and in guest rooms for delegates who booked accommodations with the Hyatt Regency. Instructions to access wifi while in individual guest rooms are provided by the hotel upon check-in.

IAC Pre-Conference Workshops

July 15th – 17th, 2019

All pre-conference workshops will be held at SFU Harbour Centre (515 W Hastings St, Vancouver, BC V6B 5K3, Canada) which is a short 10-15 minute walk from the conference venue. For more information, please visit <http://internationalattachmentconference.com/workshops/>

Reflective-Functioning (RF) Training (July 15-16, 2019)

10:00 am – 3:30 pm

Led by: Dr. Howard Steele

Attachment-Focused Coding System for Story Stems (July 16-17, 2019)

9:00 am – 5:00 pm

Led by: Dr. Allison Splaun

Video Intervention Therapy (VIT) (July 17, 2019)

9:00 am – 4:00 pm (one-day)

Led by: Dr. George Downing

Resilience for Attachment Researchers and Practitioners: Protecting Ourselves from Secondary Traumatic Stress (July 17, 2019)

1:00 pm – 4:30 pm (half-day)

Led by: Dr. Patricia K. Kerig

Connect: Attachment, Adolescence & Intervention (July 17, 2019)

9:30 am – 4:00 pm (one-day)

Led by: Dr. Marlene Moretti

Emotionally Focused Therapy with Trauma Couples: Guiding Principles for Effective Practice (July 17, 2019)

Time: 9:00 am – 5:00 pm (one-day)

Led by: Dr. Veronica Kallos-Lilly

Thursday July 18th

Program Overview

DAY 1	Session	Location
7:30 – 6:30 pm	Registration Open (all day)	Regency Foyer (3 rd floor)
8:45 – 9:00 AM	Welcome to Attendees and Coast Salish recognition	Regency Ballroom C/D
9:00 – 10:00 AM	Keynote: “Replication crisis lost in translation?” Dr. Marinus van IJzendoorn	Regency Ballroom C/D
10:00 – 11:00 AM	Keynote: “Evolution of emotions and empathy in the primates” Dr. Frans de Waal	Regency Ballroom C/D
11:00 - 11:30 AM	AM Refreshment Break	Regency Foyer
11:30 - 12:30 PM	Keynote: “Traumatic attachments: Relationships as sources of risk and resilience for troubled girls” Dr. Patricia K. Kerig	Regency Ballroom C/D
12:30 – 2:00 PM	Lunch Break / Clinical Discussion Panels	Various
2:00 – 3:30 PM	1 st Symposium Session 1 st Poster Session	Various
3:30 – 4:00 PM	PM Refreshment Break	Regency Foyer
4:00 – 5:30 PM	2 nd Symposium Session 2 nd Poster Session	Various
5:30 – 7:30 PM	Welcome Reception	Perspectives Level (34 th floor)

Friday July 19th

Program Overview

DAY 2	Session	Location
8:00 AM – 5:30 PM	Registration Open (all day)	Regency Foyer (3 rd floor)
9:00 – 10:00 AM	Keynote: “Representing attachment: The future is open” Dr. Carlo Schuengel	Regency Ballroom C/D
10:00 – 11:00 AM	Keynote: “Is attachment theory a moral development theory?” Dr. Ross A. Thompson	Regency Ballroom C/D
11:00 - 11:30 AM	AM Refreshment Break	Regency Foyer
11:30 - 12:30 PM	Keynote: “Beyond the academic silo: Collaboration and community partnerships in attachment research” Dr. Sheri Madigan	Regency Ballroom C/D
12:30 – 2:00 PM	Lunch Break / Clinical Discussion Panels	Various
2:00 – 3:30 PM	3 rd Symposium Session 3 rd Poster Session	Various
3:30 – 4:00 PM	PM Refreshment Break	Regency Foyer
4:00 – 5:30 PM	4 th Symposium Session 4 th Poster Session	Various
5:45 – 6:15 PM	Launch of new Special Interest Research Groups (SIRG) within SEAS	Regency A & B

Saturday July 20th

Program Overview

DAY 3	Session	Location
8:00 – 10:00 AM	Registration Open (morning only)	Regency Foyer (3 rd floor)
9:00 – 10:00 AM	Keynote: “Adolescence, attachment & intervention: Promoting resilience during risky transitions” Dr. Marlene Moretti	Regency Ballroom C/D
10:00 – 11:00 AM	Keynote: “Breaking the cycle of child abuse: Addressing social isolation and impulse control with the Group Attachment-Based Intervention (GABI [®])” Dr. Howard Steele	Regency Ballroom C/D
11:00 - 11:30 AM	AM Refreshment Break	Regency Foyer
11:30 - 12:30 PM	Keynote: “Attachment science in action: Integrating the field of adult psychotherapy” Dr. Sue Johnson	Regency Ballroom C/D
12:30 – 2:00 PM	Lunch Break / SEAS General Meeting	Prince of Wales
2:00 – 3:30 PM	5 th Symposium Session 5 th Poster Session	Various
3:30 – 4:00 PM	PM Refreshment Break	Regency Foyer
4:00 – 5:30 PM	6 th Symposium Session 6 th Poster Session	Various
5:30 PM	Closing Ceremony	Regency C/D

Clinical Discussion Panel 1.1

12:30 – 2:00 PM

Location: Regency A

Attachment Goes to Court – A Panel Discussion

Chair: Robbie Duschinsky

Panelists:

Danya Glaser

Pehr Granqvist

Avi Sagi-Schwartz

Miriam Steele

Marinus van IJzendoorn

In this panel, we discuss the use of attachment theory and research in the family courts. The discussion focuses on two areas: (1) custody decisions following divorce and (2) forensic assessments of children for whom abuse, neglect or risk for hampered development is suspected.

Much of the controversy about attachment in the family courts rests on speculations and diverse interpretations of attachment theory, rather than on cumulative evidence-based research. This panel discussion – comprised of a mixed international panel of presenters with diverse practice- and research-based backgrounds – will raise central issues and research needs in order to facilitate responsible court practice and policy directions that will minimize developmental risks and maintain appropriate child-caregiver relationships.

Clinical Discussion Panel 1.2

12:30 – 2:00 PM

Location: Regency B

A “family” of Attachment-Based Relationship Enhancement Programs for Couples and Families with Teenagers

Chair: Veronica Kallos-Lilly

This series of presentations will introduce Dr. Susan Johnson’s attachment-based relationship enhancement program, Hold Me Tight®: Conversations for Connection (HMT®) and two of its adaptations: Healing Hearts Together (HHT) for couples with a cardiac patient and Hold Me Tight® / Let Me Go (HMT®/LMT) for families with adolescents. In these programs, participants are led through a series of lectures, illustrative videos, and exercises in a group format. The lectures and visuals are designed to be evocative, priming attachment security. The arc of the HMT® programs invite collaboration and increasing connection between family members. Participants are supported through a series of exercises into deeper conversations about their interaction patterns, emotions and needs. Illustrative examples will be provided in the presentations. Preliminary research shows positive results in several areas of relationship satisfaction and attachment security. Unique aspects of each of the identified programs will be highlighted and preliminary research will be summarized.

The Hold Me Tight® relationship enhancement program: The original groundbreaking program for couples.

Carol Flynn & Veronica Kallos-Lilly

An attachment-based intervention for cardiac patients and their partners: Preliminary results from the Healing Hearts Together program

Heather Tulloch, Paul S. Greenman, Natasha Demidenko, & Sue Johnson

The Hold Me Tight® / Let Me Go conversations for connection program: Strengthening relationship bonds in families with adolescents

Nancy Aikin & Paul Aikin

Symposium Session 1.1

2:00 – 3:30 PM

Location: Regency C/D

The Social Neuroscience of Human Attachment

Chair: Pascal Vrtička

This symposium aims at illustrating how state-of-the-art social neuroscience techniques can be fruitfully combined with well-established attachment measures to inform and extend attachment theory during the 21st century. The four individual papers present social neuroscience data relating to genetics (genotype of plasticity genes) and epigenetics (receptor gene methylation), peripheral hormones (oxytocin, dopamine), mother-to-infant gaze, brain activity in single persons (EEG and fMRI), as well as brain-to-brain synchrony in dyads using fNIRS hyperscanning. These data are associated with attachment measured by self-reports, the Strange Situation Paradigm, the Adult Attachment Interview, as well as behavioral ratings from video-recordings during parent-child interaction. Integrating all of the above aspects, the last paper furthermore proposes a functional neuro-anatomical framework of human social relationships and attachment, identifying four principal components as part of a prototypical attachment interaction. This framework could be used in the future to address several emerging themes and unresolved debates of attachment theory.

Parenting interacts with plasticity genes in predicting preschoolers' behaviour

N. Letourneau, J. De Koning, B. Sekhon, H. Ntanda, M. Kobor, A. Deane, D. Dewey, T. Campbell, G. Giesbrecht, & the APron Team

Maternal cognition predicts mother-infant bonding

David W. Haley, Joanna Dudek, Mohammad Ali, & Leonardo Venturoso

About face: A fresh look at child development and attachment through the eyes of neuroscience

Lane Strathearn

The social neuroscience of human attachment: State-of-the-art and future directions

Pascal Vrtička, Jonas G. Miller, Allan R. Reiss, Martin Debbane, Trinh Nguyen, Stefanie Hoehl, Willem Verbeke, Tsachi Ein-Dor, & Michal Mokry

Symposium Session 1.2

2:00 – 3:30 PM

Location: Regency A

Attachment and Internalizing Symptoms within Individuals and Between Generations

Chair: Sheri Madigan & Or Dagan

Discussant: Jessica Borelli

Anxiety and depression are two of the most frequently diagnosed psychological disorders, with persistent patterns of impairment evident from childhood to adulthood. Bowlby (1973) theorized that attachment patterns may play an etiological role in depressive and anxiety disorders; accordingly, substantial research efforts examining the association between attachment and both depression and anxiety have followed. This symposium offers insights from meta-analytic and experimental studies that examine the link between attachment and internalizing symptoms in adults, and their influence on offspring's socioemotional and behavioral development. Discussion will focus on clinical implications that may inform approaches to intervention, which may benefit the well-being of both the adults and their offspring.

The link between adult attachment security and anxiety: A meta-analysis

Or Dagan, Christopher Facompré, Marissa Nivison, Glenn Roisman, & Kristin Bernard

Associations between prenatal anxiety and child socio-emotional outcomes: A meta-analysis

Nicole Racine, Jessica E. Cooke, Pasco Fearon, George Tarabulsky, & Sheri Madigan

Pathways of transmission from maternal adverse childhood experiences, attachment style, and mental health to offspring behavioral problems

Jessica E. Cooke, Nicole Racine, Andre Plamondon, Suzanne Tough, & Sheri Madigan

Symposium Session 1.3

2:00 – 3:30 PM

Location: Regency B

Romantic Relationship Quality During the Transition to Parenthood: Significance for Emerging Parent–Infant Attachment

Chair: Laura M. River

Discussant: Jeffry A. Simpson

The transition to parenthood (TTP) is often challenging for parents' romantic attachment relationships; yet, romantic relationships may be especially important for new parents' well-being and the developing baby's attachment. Surprisingly, limited research has assessed effects of romantic relationship quality on family functioning during the TTP. This three-study symposium delineates pathways between romantic relationship quality and several factors that are important for a healthy parent–infant attachment—parents' mental health, parent–infant bonding, coparenting relationship quality, and reflective functioning—during pregnancy and the postpartum period.

A renowned discussant will integrate findings across presentations to a) synthesize how romantic attachment relationships affect adaptation to parenthood and b) inform interventions to optimize families' well-being during the TTP. Together, these studies yield critical insights into romantic relationship problems that pose risk for insecure parent–infant attachment, and suggest targets for intervention to improve family functioning during this sensitive developmental transition.

Past made present: The legacy of childhood maltreatment for prenatal romantic relationship quality and psychopathology

Laura M. River, Angela J. Narayan, Victoria M. Atzl, Luisa M. Rivera, & Alicia F. Lieberman

Prenatal relationship satisfaction is associated with prenatal and postpartum bonding for fathers, but not mothers.

Alyssa R. Morris, Mona Khaled, & Darby E. Saxbe

I got you, babe: Partner reflective functioning is protective across the transition to parenthood

A. Goldstein, H. Kate St. John, J. Casián, C. Pettit, A. Slade, D. Shai, & J. L. Borelli

Symposium Session 1.4

2:00 – 3:30 PM

Location: Prince of Wales

Attachment in Adolescence

Chair: Lavinia Barone

This symposium focuses on attachment during the adolescent developmental period. The first paper prospectively examines the transfer of early to late adolescents' attachment figures employing a 6-wave two-year longitudinal design. The second paper explores change and continuity in the composition, morphology, and strength of adolescent attachment networks in two-wave longitudinal data collected across a three-month period. The third paper addresses daily variations of anxiety and avoidance and explores how insecure attachment style, general level of stress, and daily stress are associated with these variations. The final paper assesses the stability and change of attachment representations among Polish adolescents. Research implications are discussed.

Transfer of primary attachment figures from early to late adolescence: Four-cohort and six-wave longitudinal research

Tomotaka Umemura, Lenka Lacinová, Dana Juhová, & Lenka Pivodová

Stability and change in attachment hierarchies: An examination of adolescent social networks

Musheera AnisAbellatif, Irene Harper, Qijuan Fang, Clara Pierskalla, Etienne Gnimpieba, & Harry Freeman

Daily variations in adolescent romantic attachment and daily stress: A multilevel modeling approach.

Andréanne Lapierre, Alison Paradis, & Martine Hébert

Attachment representations among Polish adolescents: Results from a longitudinal study

Ilona Skoczeń & Karolina Głogowska

Symposium Session 1.5

2:00 – 3:30 PM

Location: Regency E

“What is your child like?” Using the Five-Minute Speech Sample to Assess Parental Reflective Functioning across Challenging Parenting Contexts

Chair/Discussant: Lela Rankin Williams

Parental reflective functioning refers to the caregiver’s capacity to reflect on the internal mental experiences of their child and of themselves. Interpersonal, developmental, and environmental risk factors limit opportunities for parents to develop high parental reflective functioning, which is costly to infants’ development and attachment. The Reflective Functioning Five-Minute Speech Sample (RF-FMSS) is an innovative measure that can efficiently assess parental reflective functioning across development. The collection of papers in this symposium includes diverse parents, parenting across challenging contexts: foster parents, fathers in jail, and teenage mothers. This international symposium highlights the potential for the RF-FMSS to be used as a tool to assess improvements in parental reflecting functioning, and subsequent caregiver-child attachments, across child development.

The development and application of a new short interview for assessing parental reflective functioning: The reflective functioning five-minute speech sample

Tina Adkins

Using the five-minute speech sample to assess reflective functioning in young mothers who babywear: A prospective study

Molly Gebler & Lela Rankin Williams

Fatherhood in jail: Assessing parental reflective functioning using the five minute speech sample

Chiara Bastianoni, Simone Charpentier Mora, Fabiola Bizzi, Claudia Chiarolanza, & Donatella Cavanna

Symposium Session 1.6

2:00 – 3:30 PM

Location: Oxford

Trauma, Attachment and Intervention

Chair: Howard Steele

This symposium focuses on trauma, attachment, and interventions. The first paper explores the association between human mothers' pre-conception stress and DNA methylation profiles in their biological infants. The second paper examines the effect of discussing loss/trauma in the Adult Attachment Interview (AAI) on autonomic nervous system reactivity, moderated by being classified as unresolved/disorganised. The third paper investigates the impact of maternal attachment representation on the interaction with their child in mother-infant-dyads by focusing on synchrony in maternal narratives and behavior. The final paper examines the process and outcomes of Emotion-Focused Family Therapy (EFFT), a trans-diagnostic intervention that combines psycho-education and experiential exercises to empower parents with the skills they need to support their child's recovery. Findings are discussed in the context of trauma and attachment theory.

Maternal adverse childhood experiences and infant DNA methylation

Sarah Moore, Bikram Sekhon, Michael Kobor, Meaghan Jones, Gerald Giesbrecht, & Nicole Letourneau

Psychophysiological responses underlying the discussion of unresolved loss and trauma in the Adult Attachment Interview

L. Bakkum, M. Oosterman, M. L. Verhage, F. C. Kunseler, R. M. Pasco Fearon, C. Schuengel, & R. Duschinsky

Relationship between maternal attachment representations and parenting focusing on representational and behavioral synchrony

Anna Buchheim, Stefan Pfänder, Carl E. Scheidt, Daniel Mandel, Franziska Köhler-Dauner, Christiane Waller, Cornelia Doyen-Waldecker, Harald Gundel, Jörg M. Fegert, & Ute Ziegenhain

Emotion-Focused Family Therapy (EFFT): Empowering parents to break-away from the intergenerational cycle of intrafamilial trauma

Mirisse Foroughe, Kristina Cordeiro, Laura Goldstein, Eric Goodcase, & Robert T. Muller

Symposium Session 1.7

2:00 – 3:30 PM

Location: Balmoral

Employing Attachment Theory to the Study of Children with Intellectual Disability

Chair/Discussant: Rinat Feniger-Schaal

Attachment theory is a powerful theoretical and empirical framework for the investigation of the socioemotional development of children. The topic of attachment of children with intellectual disability (ID) has received increasing research attention over the past 15 years, however, the empirical evidence is still limited, and some important questions remain unanswered. The specific characteristics of children with ID demand that we go back to explore fundamental questions regarding these children. Do children with severe or profound ID differentiate between their main caregiver to strangers? What is the distribution of attachment classifications among children with non-specific ID? Are constructs such as maternal sensitivity applicable in a similar way? The studies presented will provide some empirical evidence to answer these questions.

Stress and comfort provided by parents versus strangers in children with severe or profound intellectual disabilities: Does it make a difference?

Sien Vandesande, Guy Bosmans, Paula Sterkenburg, Wim Van Den Noortgate, Carlo Schuengel, & Bea Maes

Attachment quality of children with intellectual disability and its link to maternal interactive behavior

Tirtsa Joels & Rinat Feniger-Schaal

The effect of m-learning on sensitive and responsive caregiving of persons with moderate or mild intellectual disabilities: A randomized controlled trial

Paula Sterkenburg, Evelien van Wingerden, & Mirjam Wouda

Symposium Session 1.8

2:00 – 3:30 PM

Location: Regency F

Attachment, Trauma and the Body: Diverse Applications of the Mirror Interview

Chair/Discussant: Miriam Steele

The innovation of the “Mirror Interview” (Kernberg, Normadin, & Buh-Nielsen, 2006) provides a unique empirical assessment of aspects of body representations including body esteem, levels of coherence and reflective functioning, and verbal and non-verbal expressions of affect. This symposium will feature presentations from a range of studies using the Mirror Interview in different clinical, developmental, and cultural contexts.

Data from a clinical sample of adolescents with personality disorders explores a split in the “self-as-seen” with the “self-as-felt” connecting the role of body esteem and alienation. Another study focusing on the intergenerational transmission of body representations from mothers to their toddlers and older children will be presented, and a study of the experiential component of “in the mirror” versus “face-to-face” interview administrations. Another study investigates the use of the Mirror Interview with male participants identifying as heterosexual or homosexual. A third study examines the Mirror Interview in Western and non-Western contexts with data collected from a sample of adolescents from Tanzania.

The Mirror Interview across generations and across contexts

Tiffany Haick, Hannah Knafo, Kristin Tosi, Esther McBirney-Goc, & Miriam Steele

Body and attachment representations in a sample of men

Anthony Boiardo & Cicek Erdem

The Mirror Interview: In clinical and non-Western contexts

Bernadette Buhl-Nielsen

Poster Session 1

2:00 – 3:30 PM

Location: Regency Foyer

Poster Number	Title	Presenting Author
P100	Mindful parenting and youth depression and anxiety	Julia Vernon
P101	Use of secure base by 4-year-old children of low-middle socioeconomic status in the Colombian Caribbean region	Flor Parra Badel
P102	Coparenting and parental partnership in a triadic setting: Associations with parental sensitivity and child-parent attachment	Audrey-Ann Deneault & Jean-François Bureau
P103	Attachment representations in the narratives and drawings of a sample of preschool Greek children and associations with conduct problems and harsh discipline	Angeliki Kallitsoglou
P104	Maternal autonomy support, maternal sensitivity and social competence in a low SES sample of preschoolers from Lima (Peru)	Magaly Nóbrega
P105	Paternal role and father involvement in adolescent fathers: A case study.	Liliana Suárez
P106	The mothers of ambivalent-resistant children: The childhood and caregiving experience of gamma mothers	Cherry Chan
P107	Secure base script development in middle childhood: A 9-year longitudinal study of urban Chinese families	Rui Yang
P108	Attachment in middle childhood: Predicting prosocial behavior beyond the effect of reflective functioning	Natalie Christner

Poster Session 1 Continued

2:00 – 3:30 PM

Location: Regency Foyer

Poster Number	Title	Presenting Author
P109	The relationship between dimensions of maternal parenting and child's attachment in families of varying socio-economic status	Karolina Glogowska
P110	The mediating role of attachment and affect regulation between parental behavior and adolescent mental health	Jose Mari del Casal
P111	Attachment representations in early adolescence are associated to mothers' perception of the dyadic communication quality	Ora Aviezer
P112	Intergenerational transmission of caregiving system: From mother and father to adolescent child in triad-data	Keisuke Okubo
P113	Best friend dyads and groups: Rural adolescents friendship types as a predictor of attachment to parents and peers	Clara Pierskalla
P114	Primary attachment to parent or peers as a predictor for adolescent mental health	Irene Harper
P115	Adolescent attachment and emotional problems among teens: The roles of parental adult attachment	Lin Bao
P116	Peer relationships and stigmas influence on help-seeking for mental health difficulties: Exploration among student athletes	Keith Hamilton
P117	Parenting behaviours associated with parental and youth perceptions of youth substance use	Rajan Hayre
P118	Parent-teen attachment and conflict report discrepancies	Emily M. Thornton

Symposium Session 2.1

4:00 – 5:30 PM

Location: Regency C/D

A Family Systems Perspective on Fathers and Attachment

Chair: Carolyn Pape Cowan & Elia Psouni

This invited symposium presents a preview of forthcoming Special Issue of the journal *Attachment and Human Development*: “A Family Systems Perspective on Fathers and Attachment” (in press). The symposium includes reports from five of the six research teams included in the issue, located in the USA, Germany, and Sweden. Papers include 3 correlational studies and 2 randomized controlled trial interventions, each one demonstrating how data from fathers contributes to the understanding of mothers’, fathers’, and children’s adaptation. A family systemic approach to fathers’ roles in attachment studies is reinforced by the fact that in four of the five studies the relationship between the parents, especially their ability to regulate conflict and disagreement, plays a key role in the transmission of attachment and adaptation across generations.

In a father’s mind: Paternal reflective functioning, sensitive parenting, and protection against socioeconomic risk

Katherine V. Buttitta, Patricia A. Smiley, Margaret L. Kerr, Hannah F. Rasmussen, Francesca R. Querdasi, & Jessica L. Borelli

The influence of attachment representations and co-parents’ scripted knowledge of attachment on fathers’ caregiving representations

Elia Psouni

Emotional insecurity in relation to mother and father – gender differences in links to parenting, interparental conflict and the parent-child-relationship

Ulrike Lux & Sabine Walper

Intervention effects on infant-father attachment

I. Walter, S. Landers, J. Quehenberger, & K. H. Brisch

Fathers’ and mothers’ attachment styles, couple conflict, parenting quality, and children’s behavior problems: An intervention test of mediation

Philip A. Cowan, Carolyn Pape Cowan, Marsha Kline Pruett, & Kyle Pruett

Symposium Session 2.2

4:00 – 5:30 PM

Location: Regency F

Opportunities and Challenges for implementing Attachment-Based Programs for Caregivers of Children in Child Welfare Services

Chair: Dave Pasalich

Children in out-of-home care navigate many traumatic stressors when placed with their kin or foster parents. Birth families also experience unique challenges when children are being reunified. Without proper family support, difficulties in the caregiver-child relationship may escalate and precipitate placement breakdowns. There are various opportunities for providing crucial support to families involved with child welfare services; however, randomized controlled trials (RCTs) of tailored parent programs for these families are scarce. Here we present on recent or ongoing RCTs of attachment-based programs focused on enhancing caregiver sensitivity, relationship quality, and child developmental outcomes. These include a group program for kinship parents in Australia, a video-feedback intervention for foster parents in the Netherlands, and a home visiting program in the USA to support birth parents during family reunification. We conclude by discussing how we can improve attachment-based practice across the child welfare system, and describe recent efforts to support public agencies with implementing relational interventions.

Early findings from a randomized controlled trial of an attachment- and trauma-informed program for kinship parents

Dave S. Pasalich & Marlene M. Moretti

Positive parenting in foster care: Effects of a video-feedback intervention program on foster parents' behavior and attitudes

Nikita K. Schoemaker, Femmie Juffer, Ralph C. A. Rippe, Harriet J. Vermeer, Marije Stoltenborgh, Athanasios Maras, & Lenneke R. A. Alink

Lessons Learned: Challenges faced by recently reunified birth families in their participation in an attachment-based home visiting program

Monica Oxford, Susan Spieker, Mary Jane Lohr, & Anthippy Petras

Philanthropy as a means of improving outcomes for kids in the United States child welfare system

Tracey Field

Symposium Session 2.3

4:00 – 5:30 PM

Location: Prince of Wales

Unresolved-Disorganized Attachment Across the Lifespan

Chair: Marie-José van Hoof

This symposium focuses on unresolved-disorganized attachment across the lifespan. The first paper presents video clips of child-parent interactions to illustrate examples of disorganized behavior in the preschool and school-age periods from a sample of children in foster and adoptive care. Additionally, a case presentation using an Attachment Security model of intervention will be discussed. The second paper examines the associations among mother-infant security, insecurity and disorganization of attachment, mothers' insightfulness/reflective functioning into their infants' internal experience and maternal sensitivity. The third paper investigates neural correlates of unresolved-disorganized attachment and a general psychopathology factor with grey and white matter of the brain and functional connectivity of the brain in rest. The final paper reviews the literature for studies of clinically diagnosed post-traumatic stress disorder or borderline personality disorder, and their relation to unresolved attachment status as assessed by the Adult Attachment Interview (AAI), including the rare category, "cannot classify" with reported incidences of unresolved attachment. Findings on disorganized behavior will be discussed in the context of an attachment framework, and clinical implications presented.

Disorganization in the preschool period, middle childhood, and beyond

William F. Whelan

Exploring the ontogeny of infants' disorganized attachment: The contribution of maternal sensitivity, maternal attachment and emotional regulation

Marina Fuertes, Joana L. Gonçalves, Fernando Ferreira-Santos, & Pedro Lopes-dos-Santos

Unresolved-disorganized attachment and psychopathology in the adolescent brain

M. J. van Hoof, M. M. E. Riem, A. S. Garrett, J. N. Pannekoek, S. A. R. B. Rombouts, N. J. A. van der Wee, M. H. van IJzendoorn, & R. R. J. M. Vermeiren

Unresolved attachment status marks a more than twofold greater risk for Post-Traumatic Stress Disorder and borderline personality disorder - a meta-analysis

Frances Nkara

Symposium Session 2.4

4:00 – 5:30 PM

Location: Balmoral

Reflective Functioning, Mindfulness & Attachment

Chair: Marian Bakermans-Kranenburg

This symposium focuses on reflective functioning, mindfulness, and attachment. The first paper examines the link between parental reflective functioning and attachment security as assessed in a modified strange situation paradigm in school-aged foster and adopted children. The second paper evaluates the contributions of trauma-specific reflective functioning and parental reflective functioning to mothers' ability to interpret child's thoughts and feelings. The third paper provides novel evidence for a link between theory of mind and face processing, and may indicate that a shared motivation/reward system supports these two important components of social cognition and parenting. The final paper consists of two studies exploring the longitudinal relationship between adult attachment and mindfulness, and the bi-directionality of this association by comparing the effects of attachment security priming and mindfulness induction methods. Implications for treatment are discussed.

An empirical link between parental reflective functioning and attachment security in school-aged foster and adopted children

Somer A. George

Thinking the unthinkable: Mentalizing trauma is crucial to see things from the child's eyes

Julia Garon-Bissonnette, Roxanne Lemieux, Maria Muzik, Valerie Simon, Rena Menke, & Nicolas Berthelot

Better mind readers, better face readers: Theory of mind predicts cortical sensitivity to infant facial cues

David W. Haley, Joanna Dudek, Mohammad Ali, & Leonardo Venturoso

Attachment style predicts mindfulness, both longitudinally and experimentally

J. C. Stevenson, L. Emerson, F. Sirois, A. Rowe, & A. Millings

Symposium Session 2.5

4:00 – 5:30 PM

Location: Regency E

Childhood Adversity and Adult Attachment: The Role of Secure Base Scripts

Chair: Theodore E. A. Waters & K. Lee Raby

The secure base script is rooted in early caregiving experiences and impacts functioning across the life course. Research on the secure base script has largely focused on moderate-risk samples and the normative range of parent-child relationship experiences. This symposium brings together new research highlighting the significance of adults' secure base scripts within the context of adverse caregiving experiences. The first paper leverages prospective, longitudinal data to describe how abuse and neglect during childhood undermines the development of the secure base script. The next paper demonstrates that failure to develop the secure base script leads to increased vulnerability to the harmful impact of childhood adversity on symptoms of depression. The third paper reports that a parenting-focused intervention facilitated the acquisition of the secure base script in a sample of mothers referred to Child Protective Services and that the secure base script may influence parenting behavior among this group of high-risk parents.

Secure Base Script Development and Childhood Experiences of Abuse and Neglect: A Prospective Longitudinal Study

Theodore E. A. Waters, Christopher R. Fagot, K. Lee Raby, Marissa D. Nivison, Sophia W. Magro & Glenn I. Roisman

Secure Base Script Knowledge Moderates the Association Between Childhood Adversity and Mothers' Depressive Symptoms

Christopher R. Fagot, Amy Hyeon Lee, Galia Nissim, Steven Imrisek, Or Dagan & Kristin Bernard

Increasing secure base script knowledge of high-risk mothers with an attachment-based parenting intervention

K. Lee Raby, Theodore E. A. Waters, Alexandra R. Tabachnick, Lindsay Zajac & Mary Dozier

Symposium Session 2.6

4:00 – 5:30 PM

Location: Regency B

Attachment and Stress Physiology: From Mechanisms to Intervention

Chair: Kristin Bernard

Dysregulation of children's stress physiology reflects an early marker of disease vulnerability, exacerbating risk for mental and physical health problems across the lifespan. This symposium explores the role that parental sensitivity and attachment play in shaping children's physiological regulation and reactivity from infancy through middle childhood. By examining multiple physiological systems (i.e., hypothalamic pituitary adrenal [HPA] axis, autonomic nervous system [ANS]), various indicators of attachment (i.e., parental [in]sensitivity, attachment in middle childhood), and various types of stressors (e.g., sociodemographic risk, maltreatment history, hypothetical situations involving the activation of attachment needs) across developmental periods, this diverse yet complementary set of presentations will advance our understanding of mechanistic links between parenting, attachment, and children's stress physiology – offering critical directions for future research and novel targets for intervention.

Sociodemographic Risk and Insensitive Parenting Predict Blunted Cortisol Rhythms in Infancy

Laura Perrone, Allison Frost, Sierra Kuzava, Galia Nissim, Suzanne Vaccaro & Kristin Bernard

Parental Sensitivity Mediates the Sustained Effects of the ABC Intervention on Cortisol in Middle Childhood

Mallory Garnett, Kristin Bernard, Julie Hoye, Lindsay Zajac & Mary Dozier

School-aged Children Exhibit Differential Patterns of Physiological Activation to Secure Base Resolutions to Attachment Needs

Gerin Gaskin, Debbie Chung & Jessica L. Borelli

Symposium Session 2.7

4:00 – 5:30 PM

Location: Oxford

Attachment, Kinship and Foster Care

Chair: Carlo Schuengel

This symposium focuses on attachment, kinship, and foster care. The first paper is a longitudinal study examining parental commitment with birth parents while considering contact and birth parent's depression symptoms. The second paper examines associations between demographic (prematurity, sex, Indigeneity) and descriptive factors (length of time in foster care, training of caregivers, frequency of intervention and assessments, type of foster care) on the development of children aged 2-60 months in foster care who receive the Developmental Support Plan (DSP) program. The third paper examines whether foster parent commitment moderated the effectiveness of Attachment and Bio-behavioral Catch-up (ABC) on changes in parental expressions of delight. The final paper assesses whether Reactive Attachment Disorder or Disinhibited Social Engagement Disorder symptoms are associated with functional impairment in out-of-home care children, and whether these associations remained after taking in account other symptoms of psychopathology. Findings are discussed in the context of informing health promotion, and clinical implications are presented.

Parental commitment: Views on parenting and psychological distress throughout placement trajectory

A. De Serres-Lafontaine, S. Porlier, & K. Poitras

Factors predicting the effectiveness of the Developmental Support Plan (DSP) program for children in Alberta foster care

Jelena Komanchuk, Nicole Letourneau, Chaya Kulkarni, Henry Ntanda, James Reynolds, & Calgary Region Children's Services

Examining foster parent commitment as a moderator of intervention effectiveness

Allison Dash, Andrea Minor, Kristin Bernard, Christiana Martin, & Mary Dozier

Do attachment disorders predict functional impairment in out-of-home care children?

Maude Archambault, Sébastien Monette, & Chantal Cyr

Symposium Session 2.8

4:00 – 5:30 PM

Location: Regency A

Attachment and Caregiving within the Family Context

Chair/Discussant: Deborah Jacobvitz

Family-level interaction patterns are powerful predictors of children's well-being, sometimes more so than interactions within specific family dyads. All three papers draw on attachment and family systems theory to examine relations among attachment, caregiving, and marital relationships within families to understand why some are better able to create optimal family interactions. Aviles found that negative marital interactions predict role-reversed caregiving for both parents, but particularly fathers. The other papers underscore the value of examining joint and individual attachment representations and relationships when analyzing family functioning. Tian found that joint infant-mother and infant-father attachment predict controlling and unbalanced triadic family interactions. Examining mixed pairs (Msecure/Finsecure; Fsecure/Minsecure) revealed different pathways for infants' attachment security with mother and father. Poulsen found that couples' joint attachment representations, assessed prenatally, predict later parents' perceptions of their spouse as caregivers, which in turn predict triadic interaction quality. Implications for developing early family interventions will be discussed.

Antecedents and consequences of early parent-child role reversal and relations with toddler autonomy

A. I. Aviles, S. Reisz, D. Jacobvitz, & N. Hazen

The origins of triad family interactions: The role of infants' joint attachment relationship with mother and father

Z. Tian, N. Hazen, & D. Jacobvitz

Parents' joint attachment representations predict triadic family interaction quality across the transition to parenthood

Helen Poulsen, Nancy Hazen, & Deborah Jacobvitz

Poster Session 2

4:00 – 5:30 PM

Location: Regency Foyer

Poster Number	Title	Presenting Author
P200	Mothers' Adult Attachment Style and their Information Processing of Hypothetical Stressful Situations Involving Their Child	Efrat Sher-Censor
P201	Attachment and Political Institutions – Attachment Style Predicts Lower Levels of Both Social and Institutional Trust	Joel Gruneau Brulin
P202	Maladjustment of Chinese International Students: What role does Attachment Security Play?	Hongdi Wang
P203	Nonverbal and Paralinguistic Behaviors During the Adult Attachment Interview: The Construction of a Novel Coding System	Laura Goldstein
P204	Standing On The Other Side	Joanne Crandall
P205	Parents' Adverse Childhood Experiences and Sensitive Parenting: The Mediating Role of Depression	Allison Lazzaro
P206	The Japanese mothers' narrative of "Amae" in the Adult Attachment Interview	Kiyomi Kondo-Ikemura
P207	Increased awareness of attachment figures' faces in response to stress: Using a continuous flash suppression paradigm in adults	Farnaz Mosannenzadeh
P208	Supporting Secure Attachment in Non-Monogamous Relationships through Couples Counselling: Case Studies from Clinical Practice	Lauren Shay
P209	Rejection Sensitivity Moderates the Coupled Change of Interpersonal Stressors and Depressive Symptoms in Undergraduate Students	Christina Robillard
P210	Relationship Satisfaction and Substance Use in First-Year Sexual Minority Students: The Moderating Role of Rejection Sensitivity	Julie Prud'homme

Poster Session 2 Continued

4:00 – 5:30 PM

Location: Regency Foyer

Poster Number	Title	Presenting Author
P211	Should I Stay or Should I Go? - Relationship satisfaction and the influence of attachment	Anna Blomkvist
P212	Links Between Adolescent Secure Base Representations and Expectations of Future Romantic Relationships	Megan H. Fitter
P213	Korean pregnant couples' attachment representation for parents of origin, psychological symptoms and romantic attachment	Jin-Young Chae
P214	Rejection Sensitivity and Risky Sexual Behaviours Over Eight Months: The Moderating Role of Relationship Status	Carolyn E. Helps
P215	Attachment Insecurity Predicts Declines in Sexual Desire and Satisfaction in Mixed-sex Couples Over One Year	Richard A. Rigby
P216	Attachment and loneliness in romantic relationships of adults - generational comparison	Monika Kornaszewska-Polak
P217	Attachment as a moderator of physiological linkage in romantic partners in daily life settings	Colin Adamo
P218	Association between non-parenting adult's attachment patterns and brain structure and function: A systematic review of neuroimaging studies	Martha Hart
P219	Which role does self-focused RF have in the relation between attachment and psychological maladjustment during middle childhood?	Fabiola Bizzi

Clinical Discussion Panel 2.1

12:30 – 2:00 PM

Location: Regency A

Working Through Attachment Relationships to Improve Quality of Life for People with an Intellectual Disability

Chair: Carlo Schuengel

Panelists:

Rinat Feniger-Schaal

Paula Sterkenburg

Efrat Sher-Censor

Intellectual disability (ID) primarily affects social adaptive behavior, which in some cases may deteriorate into endangerment of self and others. People with ID are as a result overrepresented in residential settings for youth mental health care, prisons, and care homes. The regimen in many of these settings may involve the use of behavioral, pharmacological, and mechanical restraints, or seclusion. This panel brings together clinical researchers and practitioners to discuss how insights from attachment theory and research may be employed to reduce such practices, improve quality of life, and promote adaptive development. Key questions to be discussed by the panel and with the audience are: (a) how may attachment-based interventions make restraints and seclusion obsolete?; (b) how may family carers and professionals be supported in building high quality relationships with people with ID?; (c) what are clinical research priorities in this field and how should these be pursued?

Clinical Discussion Panel 2.2

12:30 – 2:00 PM

Location: Regency B

Attachment in Theory and Practice: Understandings and Misunderstandings, Applications and Implications

Chair: Robbie Duschinsky

Attachment theory and research has a great deal of relevance for clinical and social welfare practice. However, there has been relatively little empirical study of how practitioners conceptualise and draw upon attachment theory and research. This symposium offers a multimethod empirical investigation of the causes and structure of the research-practice gap, and factors that narrow it or facilitate effective reciprocal learning. Specifically, we examine understandings of key concepts, how these play out in assessments of clinical reasoning and areas of consensus and divergence between research and practice. Findings are interpreted in the context of a range of relevant historical, sociological, pragmatic, systemic and individual-level influences. The symposium will be of special value to i) researchers interested in how best to communicate with and learn from practitioners and wider publics; and ii) practitioners interested to think further about the implications of attachment theory and research for their own work.

Understanding misunderstandings of attachment theory and research: A historical and sociological perspective

Robbie Duschinsky

Understanding and use of attachment theory in UK clinical practice

Helen Beckwith

The relationship between practitioners' AAI responses and their initial assessment of family cases

Sarah Foster

Clinical Discussion Panel 2.3

12:30 – 2:00 PM

Location: Regency E

Application of Attachment Theory and Research as a Framework for a Collaborative Divorce Model and Process

Panelists:

Sonya Vellet

Yuval Berger

This presentation will explore how key concepts from attachment theory (e.g., a trusted attachment figure functions as a secure base and safe haven, repairs ruptures, and engages in appropriate limit-setting) and research (i.e., individual differences in caregiver-child and adult attachment patterns) can be applied as a framework for a collaborative divorce process. The collaborative divorce process (including the collaborative participation agreement, the cohesive functioning of the team, specialized support offered within a relational context) can represent and provide the adults with the experience of safety and ‘felt security’, that likely has been disrupted during the dissolution of the marital relationship, to support a reorganization and restructuring of the family post-separation. The collaborative divorce team also tailors the approach to the individual adult and caregiver-child attachment patterns in the family. This process also builds the parents’ relationship capacities to be able to offer ‘felt security’ to their children.

Symposium Session 3.1

2:00 – 3:30 PM

Location: Regency A

“It Takes Two”: Attachment Insecurities and Interpersonal Emotion Regulation Processes in Romantic Relationships

Chair: Yuthika U. Girme

Attachment theory postulates that early life experiences with caregivers shape the way people regulate their emotions in adulthood. However, romantic partners can also have a profound impact on emotion regulation processes. This symposium explores how interpersonal dynamics between romantic partners shape the way insecure individuals regulate their emotions. The first talk addresses how emotion regulation processes by anxious individuals can benefit anxious individuals, but incur costs to their partners. The second talk demonstrates how the suppression of emotions by anxious individuals can benefit their partners. The third talk outlines how relationship partners can engage in behaviors that help downregulate insecure individuals' destructive emotional reactions. Finally, the fourth talk demonstrates that romantic partners shape each other's ability to regulate physiological responses to stress, and accompanying behavioral and subjective responses. Taken together, this symposium highlights the importance of examining dyadic processes to understand the occurrence and impact of insecure individuals' emotion regulation.

Attachment Insecurity and the Benefits and Costs of Guilt Induction Strategies

Nickola C. Overall, Shanuki D. Jayamaha, Yuthika U. Girme, Edward P. Lemay & Matthew D. Hammond

Attachment Anxiety and the Curvilinear Effects of Expressive Suppression on Partners' Outcomes

Yuthika U. Girme, Brett J. Peters, Levi R. Baker, Nickola C. Overall, Garth J. O. Fletcher, Harry T. Reis & Jeremy P. Jamieson

Partner Buffering of Attachment Insecurity in Adulthood

Jeffrey A. Simpson & Nickola C. Overall

Spouses' Attachment Styles Shape Physiological, Behavioral, and Subjective Responses to Relational Stress

Paula R. Pietromonaco, Lindsey A. Beck, Fiona Ge, Nathan Carnes, Deborah Kashy, Holly Laws, & Sally I. Powers

Symposium Session 3.2

2:00 – 3:30 PM

Location: Regency C/D

Reflective Function, Attachment and Children’s Development: Interventions and Outcomes

Chair: Nicole Letourneau

Discussant: Miriam Steele

We present three papers focusing on parental Reflective Function (RF)—the ability to “mentalize” or envision mental states in oneself and one’s child—and relationships with child development. Bowlby theorized that children’s emotional/behavioural problems stem from lack of parental insight (or RF) into the motives underlying child behaviour. He also theorized that children’s emotional/behavioural problems link to from poor parental sensitivity and responsiveness (Bowlby, 1969/1982). Ainsworth (1969) elaborated, describing the ability to be reflective or “able to see things from Baby’s point of view” as necessary for secure infant attachment. Fonagy described connections between mothers’ and fathers’ RF and children’s development (Fonagy et al., 2012). However, while both mothers’ and fathers’ RF is theorized to directly predict children’s developmental attainment, or indirectly via improvements in qualities of parent-child relationships, evidence is scarce (e.g Allen et al., 2008). We provide empirical evidence to support these theoretical positions and inform community interventions.

Attachment & Child Health (ATTACH) Pilot Trials: Effects of Parental Reflective Function Intervention for Families Affected by Toxic Stress

Nicole Letourneau, Lubna Anis, Howard Steele, Miriam Steele & Martha Hart

The Validity of a Preventive Intervention for Vulnerable Preschoolers: Catch-ups in School Readiness Maintained into Elementary School

Howard Steele, Rachel Ganz & Rebecca Shahmoon-Shanok

Mothers’ and Fathers’ Reflective Function and Preschool Children’s Development

Elena Ali, Nicole Letourneau, Martha Hart, Lubna Anis, Travis Campbell, Liane Tomfohr-Madsen & Gerald F. Giesbrecht

Symposium Session 3.3

2:00 – 3:30 PM

Location: Regency B

Insecure Attachment and the Roots of Externalizing Behavior in Childhood and Adolescence

Chair: Patricia K. Kerig

Ever since the publication of John Bowlby's (1944) classic work on "Forty-four juvenile thieves," insecure attachment has been recognized to be a salient factor in the developmental psychopathology of child and adolescent problem behavior. Less well-understood, however, are the mechanisms that account for this association. This symposium brings together four papers from independent laboratories investigating these questions in diverse contexts and settings. The first paper examines the construct of precocious relinquishment of attachments to caregivers in a sample of traumatized youth in juvenile detention. The second paper investigates maltreated children's availability to modify their models of attachment in their relationships with professional caregivers. The third paper investigates emotion dysregulation as a mechanism underlying attachment anxiety and adolescent dating violence perpetration. The fourth paper presents the results of a prospective longitudinal study testing pathways from insecure attachment in infancy to externalizing problems during middle childhood through peer rejection and aggression.

Attachment hierarchies and precocious relinquishment of attachments to parents in a traumatized sample of justice-involved adolescents

Patricia K. Kerig & Robyn B. Kilshaw

Clinical portrait of adolescents in Quebec residential care: Potential levers and barriers for developing their sense of security

Katherine Pascuzzo, Chantal Cyr & Carole Côté

Can emotion regulation difficulties explain the association between attachment insecurities and different forms of teen dating violence?

Valérie Théorêt, Martine Hébert & Martin Blais

Pathways from infant attachment insecurity to externalizing problems in middle childhood

Anne Tharner, Ank Ringoot, Marinus van IJzendoorn, Marian Bakermans-Kranenburg & Henning Tiemeier

Symposium Session 3.4

2:00 – 3:30 PM

Location: Prince of Wales

Attachment Based Intervention for Caregivers of Adolescents – Connect

Chair: Natalie Goulter

This symposium focuses on Connect – an attachment-based intervention for caregivers of adolescents. The first paper is part of on-going longitudinal research involving three Italian centres (Pavia, Milan, Pisa) aimed at investigating whether helping parents reduce their reliance on coercive or unproductive parenting strategies and understand changes occurring during adolescence from an attachment-based perspective would reduce their adolescents' externalizing and internalizing symptoms. The second paper evaluates the effectiveness of a culturally tailored parenting support program on the mental health of Somali-born parents and their children, as well as the parents' sense of competence in parenting. The third paper examines the acceptance, uptake, and caregiver satisfaction of an adapted version of Connect which addresses the unique attachment related challenges and concerns of caregivers of trans and gender nonconforming youth. The final paper examines the relationship parenting behaviours, attachment insecurity, and callous-unemotional features (i.e., lack of empathy, limited attachment to others) using data from the Connect program. Findings add evidence to the importance of investigating mechanisms of change underlying the effectiveness of the Connect program, providing further indications on its application in therapeutic contexts.

Changes in attachment avoidance reduce adolescents' externalizing symptoms: The effectiveness of CONNECT intervention in Italy

Lavinia Barone, Nicola Carone, Antonella Costantino, Jennifer Genschow, Sara Merelli, Annarita Milone, Lisa Polidori, Laura Ruglioni & Marlene Moretti

The effects of a culturally tailored parenting programme on the mental health of Somali-born parents and their children

F. Osman, R. Flacking, U. K. Schön, R. Salari & M. Klingberg-Allvin

Transforming Connections: An Adaptation of an Attachment-Based Parent Program for Parents of Trans and Gender Nonconforming Youth

Antonia Dangaltcheva, Marlene Moretti & Chris Booth

Parent-Youth Attachment and Youth Callous-Unemotional Features

Natalie Goulter, Stephanie G. Craig & Marlene M. Moretti

Symposium Session 3.5

2:00 – 3:30 PM

Location: Regency E

Intergenerational Transmission of Caregiving

Chair: Carol George

Discussant: Carol George

This symposium presents research on intergenerational transmission of caregiving for mothers and fathers. Research examining the intersections of these behavioral systems is limited. Paper 1: Fathers' attachment representations and their behavior while feeding their infants. Compared to all other fathers, secure fathers were more attuned to their infants, dismissing fathers were less attuned, and unresolved fathers engaged in more controlling behavior. Paper 2: Intergenerational transmission patterns for maternal adult attachment representations, caregiving, and children's attachment. There is significant classification cross-over for mothers with pathological mourning and child disorganization. Maternal caregiving behavior and helplessness best predicts children's attachment. Paper 3: Caregiving behavior while mother-child dyads care for a life-like infant doll. Results show significant continuity between maternal caregiving behavior and children's infant care. Incompatible maternal caregiving messages result in children's caregiving breakdown and abdication. These studies punctuate the contributions of prior attachment experiences with caregivers and potential consequences for caregiver and subsequent child outcomes.

Fathers' attachment representations and infant feeding practices

Samantha Reisz

Pathological mourning and the transmission gap: Effects on maternal caregiving and child attachment

Steffani Kizziar

The developing caregiving system: Contributions of maternal to child caregiving

Amber Hester

Symposium Session 3.6

2:00 – 3:30 PM

Location: Regency F

Disorganization and Role-Reversal from Preschool to Young Adulthood: Links with Developmental Tasks and Adjustment

Chair: Laura E. Brumariu

Discussant: Kathryn A Kerns

We know little about associations of role-reversed disorganized attachments (punitive and caregiving) with key developmental tasks and adjustment from preschool to young adulthood (Macfie et al., 2015). This symposium increases our understanding of the developmental implications of disorganization and role-reversal. The first paper shows that parent's own history of maltreatment predicts increased role-reversal with their child at age 4 years, which, in turn, is associated with child psychopathology in middle childhood. The second paper relies on an observational measure of disorganized/disoriented and role-reversed patterns (hostile/punitive and caregiving/role-confused) in middle childhood and shows that the three disorganized patterns relate differentially with children's emotion regulation, emotion communication, as well as peer relationships, internalizing and externalizing problems. The final paper shows unique associations of disorganized and role-reversed attachments with young adults' identity development, anxiety, and depression, and highlight that disorganized and role-reversed attachments with fathers play a special role in young adults' adjustment.

Developmental Origins and Outcomes of Role Confusion in the Parent-Child Relationship

Linnea Linde-Krieger & Tuppett M. Yates

Disorganization and Role-Reversal in Later Middle Childhood: Differential Relations to Emotion Communication, Regulation, and Adjustment

Laura E. Brumariu, Kathryn A. Kerns, Kathryn A. Giuseppone & Karlen Lyons-Ruth

Investigating the Correlates of Disorganization and Role-Reversal to Identity Development and Psychological Outcomes in Young Adulthood

Jean-Francois Bureau & Molisa Meyer

Symposium Session 3.7

2:00 – 3:30 PM

Location: Oxford

Attachment in Immigrant and Refugee Families

Chair: Carlo Schuengel

This symposium focuses on attachment in immigrant and refugee families. The first paper in the symposium presents the results of an attachment-based intervention for refugee parents. Authors provide a description of program development, feedback from two workshops, and insights into future directions of the program. The second paper explores the relationship between maternal trauma and child attachment, and child behaviour difficulties in a sample of refugees to Canada. Preliminary results including prevalence rates for traumatic experiences, PTSD symptoms and depressive symptoms will be reported. The third paper explores the associations among attachment security, reflective functioning and mental health symptoms in low-income, Latinx adolescents. Results shed light on the complex interactions between these factors in this under-examined sample. Future research and clinical directions will be discussed.

Parenting through cultural change: An attachment-based intervention for refugee parents

Catherine L. Costigan, Vivien So, Cindy Quan, & Drexler Ortiz

Associations between Maternal Trauma and Child Attachment and Behaviours in Refugee Families in Canada

Jennifer Barnes & Jennifer Theule

An Exploratory Investigation of Attachment and Reflective Functioning in Children of Low-Income Latin American Immigrant Mothers

Hannah K. Hecht, Breana R. Cervantes, Rosy DePrado, Hugo Sanchez Hernandez, Christina Marquez, Melissa Pedroza, Nancy Guerra, Kirk Williams & Jessica L. Borelli

Symposium Session 3.8

2:00 – 3:30 PM

Location: Balmoral

The Importance of Physical Contact for Infants' Emotional Development

Chair: Ann Bigelow

Close body contact between mother and infant has historically been the norm; but in Western societies, modern means of infant care, such as formula feeding, institutional medical practices, and baby gear that limits contact with caregivers, have reduced the physical closeness of mother and infant. What is the cost to infants' emotional development and attachment? This symposium explores the effects of mother-infant physical contact across a variety of contexts: infant engagement and social behavior, attachment security, breastfeeding, *breastsleeping*, maternal postpartum depression, mother-infant affective touch, and long term effects on mother-child dyadic communication. The symposium by international researchers from three countries presents multiple perspectives on the effects of mother-infant physical contact on the well-being of infants, their mothers, and the developing mother-infant relationship.

Infant carrying as a tool to promote secure attachments: Comparing intervention and control infants during the Still-Face Paradigm

Lela Rankin Williams & Patricia R. Turner

The return of breastsleeping (mother-infant co-sleeping in the context of breastfeeding) to western industrialized societies: Why it needs to be supported

James J. McKenna

Short- and long-term effects of mother-infant skin-to-skin contact on the mother-child relationship

Ann Bigelow & Michelle Power

The neurobiology of attachment

Francis McGlone & Tara Kidd

Poster Session 3

2:00 – 3:30 PM

Location: Regency Foyer

Poster Number	Title	Presenting Author
P300	Attachment security and attention to facial emotional expressions in 5-year-old children: An eye-tracking study	Marina Kammermeier
P301	Understanding the VID-KIDS Intervention from the Maternal Perspective: A Hermeneutic Research Inquiry	Jennifer Bon Bernard
P302	Secure Base Script Tests in Postpartum Mothers	Sait Uluç
P303	Maternal Postpartum Depression and Child Attachment Insecurity: A Meta-analysis.	Audrey Gauthier-Légaré
P304	Mother-Infant Face-to-Face Interaction: Postpartum Maternal Depressive and Anxiety Symptoms, and Maternal Attachment Orientations	Yasemin Kahya
P305	Associations among Caesarean Section Birth, Post-Traumatic Stress and Postpartum Depression	Marie Grisbrook
P306	Patterns of Maternal Responses to Child's Distress, Misbehavior, and Exploration Attempts in the Netherlands, Poland, and Turkey	Nebi Sumer
P307	Attachment, social support and mental health trajectories in the transition to parenthood	Hava Guez
P308	Becoming a mother: The role of pregnancy anxiety, bonding to the fetus, adult attachment style and recalled parenting style.	Ariane Göbel
P309	The reliability of the 'Attune and Stimulate Mother-Infant' checklist	N. Hoffman
P310	Effects of Attachment Style on Young Adults' Capacity to Resist Smartphone Distraction while Caring for an Infant	Henry Jang

Poster Session 3 Continued

2:00 – 3:30 PM

Location: Regency Foyer

Poster Number	Title	Presenting Author
P311	The examination of the relationship between parental mind-mindedness and infants' responses during Still-Face paradigm: Mothers' comments on infants' internal states and infants' expectation of interaction	Yuri Hirata
P312	Sociodemographic Risk and Parental Sensitivity: The Mediating Role of Parent-Oriented Beliefs about Infant Crying	Cecilia Markowitz
P313	Maternal compassion preoccupation in the infant's primary care: Compassion fatigue, compassion satisfaction, and self compassion	Miriam Chasson
P314	Incorporating Affective Neuroscience into Video Intervention Therapy: a pilot family case study with children ages two and four	Tania A. Herrera
P315	Examining the association between infant stress levels and maternal-infant relationships.	Amelia LaCoste-Potter
P316	Parental hypomentalization in the face of adversity is a risk factor for infant development	Gabrielle Duguay
P317	Descriptive analyses of attachment transmission: US-Japan comparison	Kazuko Y. Behrens

Symposium Session 4.1

4:00 – 5:30 PM

Location: Regency A

Attachment in Diverse Family Forms of Same-Sex Parents

Chair: Lavinia Barone

Discussant: Howard Steele

To date, attachment research has mainly focused on heterosexual parents and their children. It remains an open question whether factors identified as enhancing child attachment security (e.g., parental sensitivity) in these families also applies to families formed by gay fathers or lesbian mothers. This exploration is particularly timely given the growing visibility of same-sex parent families worldwide and the widespread concerns that children raised outside the traditional mother-father family will be more likely to form insecure attachment relationships with their parents. The papers presented in this symposium aim at increasing our understanding of the impact of parent gender and sexual orientation, genetic relatedness, and child conception background on the quality of parent-child attachment relationship, as well as at exploring the factors associated with child attachment security, in diverse family forms of same-sex parents through adoption, donor insemination or surrogacy.

Parents' and children's socio-emotional functioning in planned lesbian mother families: The role of parental alliance

Andrea Carta & Lavinia Barone

Child attachment security and utilization of parents as safe havens and secure bases in same-sex parent families through assisted reproduction during middle childhood

Kathryn Kerns, Nicola Carone, Vittorio Lingiardi & Roberto Baiocco

Adoptive gay fathers' sensitivity and child attachment and behavior problems

Éric Alain Feugé, Chantal Cyr, Louise Cossette & Danielle Julien

Child attachment security and gay fathers' sensitivity in surrogacy families during preschool age: The role of child environmental sensitivity

Nicola Carone, Vittorio Lingiardi, Lavinia Barone & Roberto Baiocco

Symposium Session 4.2

4:00 – 5:30 PM

Location: Regency B

At the Intersection of Trauma and Attachment with Children and Adolescents

Chair: Brian Allen

The impact of trauma and maltreatment on the attachment of children is widely studied with infant and toddler populations and has greatly contributed to our understanding of normative development, in general, as well as the mechanisms of attachment more specifically. However, relatively little research has examined the impact of trauma on attachment with older children and adolescents, largely due to historical limitations in regards to assessment. This symposium will discuss various perspectives and approaches to studying the impact of trauma on the attachment of children from preschool ages through adolescence. The types of trauma examined will be diverse, ranging from sexual abuse to immigration-related experiences, and the measurement approaches will collectively include self-report questionnaires, focused interviews, and story stem completion tasks. In addition, studies will examine both developmental consequences of trauma as well as how understanding attachment may provide clues to treatment planning and success.

Disorganized attachment and emotional dysregulation as mediators of the association between sexual abuse and dissociation in preschoolers

Martine Hébert, Rachel Langevin, & Florence Charest

Childhood sexual abuse and attachment insecurity as unique and interactive correlates of children's Post-Traumatic Stress Disorder symptoms

Abigail Rozenberg, Christina Marquez, Mary Target, Peter Fonagy, Karin Ensink, & Jessica L. Borelli

The interaction of trauma and attachment in predicting the well-being of recently immigrated youth

Amanda Venta

Attachment security as a moderator of trauma-focused cognitive behavioral therapy outcomes for maltreated youth

Brian Allen, Michelle J. Chen, Ashley Bucher, Chad E. Shenk, Nancy Dreschel, & Ming Wang

Symposium Session 4.3

4:00 – 5:30 PM

Location: Regency E

Attachment and Adverse Childhood Experiences: Assessing Disorganizing Experiences

Chair: Brandi Stupica

Adult attachment researchers who cannot use the Adult Attachment Interview must employ attachment measures that were not designed to assess disorganization, which leaves a great deal of variance on the table. The Adverse Childhood Experiences (ACEs; Felitti et al., 1998) provides an opportunity to quickly assess disorganizing childhood experiences, which may pick up some of this variance that goes untapped with self-report and script assessments. We extend this emerging body of research at the intersection of attachment and ACEs with three studies on attachment and ACEs in adulthood as predictors of: romantic relationships, sibling attachment quality, and severe psychiatric symptoms and heightened difficulties with aspects of emotion regulation.

Adverse and Harsh Childhood Experiences, Attachment Insecurity, and Romantic Relationships

Brandi Stupica, Lillian Slavin & Morgan Pell

Sibling Relationships in Adverse Childhood Conditions

Marissa Nivison & Brandi Stupica

The Effects of Adverse Childhood Experiences on Emotion Regulation and Symptoms of Psychopathology in Adulthood

Hannah Knafo, Anne Murphy, Miriam Steele, Jordan Bate, Nicole Brennan, Sophie Molholm, Pierfilippo De Sanctis & Howard Steele

Symposium Session 4.4

4:00 – 5:30 PM

Location: Balmoral

Attachment in Adult Relationships

Chair: Marian Bakermans-Kranenburg

Adult attachment relationships are complex and multi-faceted. This symposium explores the range of attachment experiences in adulthood, through longitudinal studies with diverse methodologies. The first paper examines how behaviour and affect during a support discussion in the lab predicted changes in attachment anxiety and avoidance over two years in newlywed couples. The second paper explores the associations between relationship biography and former relationship quality on present partnerships. The third paper examines the influence of mother and partner bonding to the infant, mental health and substance use at 8-weeks post-birth on mother and partner-child Emotional Availability at 1-year post-birth. Dyadic influences are accounted for in these analyses. The fourth paper includes a biological component, and experimentally tested whether life history factors moderated oxytocin effects on partner preference and sexual attitudes. Future research directions will be explored.

How supportive interactions shape attachment security in newlywed couples
Rebecca J. Cobb, Marissa M. Bowsfield, & Jessica S. Ferreira

Significance of normative attachment and commitment in young adults' former relationships for current relationship quality
Ulrike Lux

Mother–infant and partner–infant emotional availability at 12 months of age: Findings from an Australian longitudinal study
Larissa Rossen, Delyse Hutchinson, Judy Wilson, Lucinda Burns, Steve Allsop, Elizabeth J. Elliott, Sue Jacobs, Craig Olsson, Jacqui A. Macdonald, C. McCormack, & Richard P. Mattick

Oxytocin supports monogamy, but differently by life history and relationship duration
Harry Freeman, Etienne Z. Gnimpieba, Jamie L. Scholl, Suma Jacobs, & Gina L. Forster

Symposium Session 4.5

4:00 – 5:30 PM

Location: Regency F

Representations and Preschool Behavior: Parents' Minds, Children's Minds, and the Behavior Between

Chair: Anne Rifkin

Discussant: Robbie Duschinsky

The preschool age is important for mental representations. First, preschoolers' behavioral signals often reflect both their feelings and estimation of current environmental stimuli, and also, future events. Parents' abilities to understand preschoolers' mental states, then, may enhance their ability to correctly interpret cues. Second, preschoolers can recall associated information and engage in future thinking, skills that serve as building blocks for burgeoning mental representations. Here, we present research relevant to parents' and children's minds at the preschool stage. We examine the moderating influence of parental Mind Mindedness upon the often observed association between parental anxiety and child behavioral problems. We consider whether Parental Reflective Functioning predicts differences in observed emotional distress and regulation during frustrating tasks. We explore the manner in which received parenting impacts neurocircuitry, especially involving the prefrontal cortex and hippocampus, to affect rudimentary working models. Our discussant provides an historical context for "mind-focused" attachment research.

Indirect Effects of Parental Mentalization and Co-parenting in the Context of Parents' Anxiety and Child Behavior

Daphna Dollberg & Keren Hanetz Gamiel

Higher Maternal Reflective Functioning is Associated with Toddlers' Adaptive Coping with Distress

Jessica L. Borelli, Hannah K. Hecht, Patricia A. Smiley, Margaret Kerr, Katherine Buttitta & Hannah Rasmussen

Attachment Relationships Meet Working Models: The Meat of the Models

Anne Rifkin-Graboi, Qiang Wang & Anqi Qiu

Symposium Session 4.6

4:00 – 5:30 PM

Location: Prince of Wales

What Attachment Based Interventions Work for Whom?

Chair: Katherine O'Donnell

This symposium focuses on factors that influence outcomes of attachment and parenting-based interventions. The first paper addresses critical moderators of the Video-feedback Intervention to Promote Positive Parenting for Sensitive Discipline (VIPP-SD) such as maternal sensitivity, education, and marital satisfaction. The second paper is a systematic review and meta-analysis of parenting outcomes and the Circle of Security (CoS) intervention. The third paper examined effectiveness of attachment- and emotion-focused interventions in comparison to other comparator interventions, on child externalizing and/or internalizing behaviour. The fourth paper explores the evidence of genetic moderation of parenting-based interventions on youth outcomes. Future applications for research and clinical work will be explored.

Who benefits the most from the VIPP program? The Moderating role of initial maternal adjustment and attachment

Nebi Sumer, Selin Salman Engin, Irem Metin Orta, Basak Sahin Acar, & Aylin Ilden Kockar

Circle of Security interventions: Can we tell what works and for whom? A systematic review and meta-analysis.

Anna Huber, Erinn Hawkins, Jessy Cooke & Sheri Madigan

Attachment- and Emotion-Focused Parenting Interventions for Reducing Internalising and Externalising Behaviours from Birth to 18

Samantha Jugovac, Dave Pasalich, Richard O'Kearney, David Hawes, Lauren Fee & Sarah McKenna

Genetic Moderators of Parenting-Based Treatment Outcomes: Meta-analysis findings and clinical implications

Katherine O'Donnell & Marlene Moretti

Symposium Session 4.7

4:00 – 5:30 PM

Location: Oxford

Attachment, Kinship and Foster Care

Chair: Dave Pasalich

This symposium focuses attachment in the context of kinship and foster care relationships. The first paper examines the experience of foster parents when caring for children with complex attachment difficulties. The second paper is a systematic review that aims to synthesize the literature on connectedness in kinship versus foster care—placements, from a holistic and culturally sensitive perspective. In addition, authors examine the associated child outcomes—of preserving connectedness. The third paper is a multi-method study that examined attachment in adolescents who were either late-adopted, placed residential care and drawn from the community, using both semi-structured interviews and self-reports. Clinical applications and future research directions will be discussed.

Exploring foster carers' experiences with children who have complex attachment problems

Peter Littleford

Connectedness in the lives of children and young people in kinship and foster care: A systematic review

Alison Hassall, Dave Pasalich, Sebastian Trew, Marlene Moretti & David Hawes

Attachment in late-adopted, residential-care and community adolescents: a multi-method comparative study.

Stefania Muzi & Cecilia Serena Pace

Poster Session 4

4:00 – 5:30 PM

Location: Regency Foyer

Poster Number	Title	Presenting Author
P400	Attachment Research Informing Practice: New Guiding Principles for Short-Term Trips Serving Vulnerable Children	Nicole Wilke & Amanda Howard
P401	Video Intervention Therapy and mentalization through the eyes of adopted children in post-adoptive life	Laura Caetani
P402	Increased Risk of Psychosis in Young Adults with a History of Foster Care Placement	Matej Markota
P403	Parental sensitivity in the context of child placement: Associations with family reunification and parental characteristics	Sarah Porlier
P404	The Parental Experience of Raising Adoptees Through Adolescence: A Rapid Literature Review of the Last Decade	Drexler L. Ortiz
P405	Examining Attachment Representation of Children Reared in Institutions, Adopted Children, and Children Living with Biological Parents in Saudi Arabia.	Mohammed Aldoreeb
P406	Healing Relational Trauma: Helping Adoptive Families Connect and Repair Attachment Difficulties through CPRT	Kristie K. Opiola
P407	Attachment development in children adopted internationally from China: the role of type of pre-adoption care and parenting	Chloë Finet
P408	Parental sensitivity, parenting goals and co-parenting in Dutch and bicultural families of the Netherlands	Camila Espinoza
P409	Validation of Russian Version of the Inventory of Parent and Peer Attachment (IPPA)	Natalia Sabelnikova

Poster Session 4 Continued

4:00 – 5:30 PM

Location: Regency Foyer

Poster Number	Title	Presenting Author
P410	Development and cross-cultural evaluation of a scoring algorithm for the Biometric Attachment Test	Susana Tereno
P411	Profile of secure base use in four children from a rural context in Colombia	Jenny A. Ortiz
P412	Prenatal Anxiety and Children’s Behavioral Problems: The Moderating Roles of Maternal-Child Attachment and Child’s Sex	Elena Ali
P413	Convergent and Discriminant Validity of the FFI	Marissa Gastelle
P414	How do parental interactions and infant temperament influence child social-emotional development? Challenges for intervention in early childhood	Diana Marcela Gómez G & María Pía Santelices A.
P415	Are child representations of attachment associated with severe conduct problems in a clinic-referred sample of young children?	Adam Johns

Launch of new Special Interest Research Groups (SIRG) within SEAS:

The Social Neuroscience of Human Attachment (SoNeAt)

Friday, July 19th, 2019

5:45 – 6:15 PM

Location: Regency A

SEAS is initiating a new Special Interest Research Group (SIRG) on The Social Neuroscience of Human Attachment (SoNeAt). The goal of SoNeAt is to promote a systematic social neuroscience approach to better describe the underlying biological and brain basis of human attachment. To achieve this goal, SoNeAt would like to bring together people from various neuroscience and psychology backgrounds so that they can share their approaches and ideas. Please join this short launch event to obtain more information on SoNeAt and, if interested, to get involved as a regular or coordinating board member.

Research, Development and Implementation of Attachment Focused and Evidence Based Clinical Applications

Friday, July 19th, 2019

5:45 – 6:15 PM

Location: Regency B

SEAS is initiating a new Special Interest Research Group (SIRG) on Development and Implementation of Attachment Based Clinical Applications. The goal of this special interest group is to promote research collaboration, development and implementation of attachment focused and evidence-based clinical applications, including assessment techniques and intervention programs. This SIRG will work to inform government and other stakeholders with high-quality and accessible information on best practice applications. We welcome those with interest to join us in this brief launch and share their ideas in shaping this new initiative, and if interested, to join as a coordinating board member.

Symposium Session 5.1

2:00 – 3:30 PM

Location: Regency A

Parent-Child Separation at the Border: Lessons from Attachment Theory

Chair: Karen Jones-Mason & Naomi Gribneau Bahm

Discussant: Miriam Steele

In the spring of 2018, the Attorney General of the United States issued a memorandum declaring a “zero tolerance policy” under which all adults entering the United States illegally would be criminally prosecuted, and, if traveling with minor children, the children would be forcibly separated from their parents. Eventually, the government was ordered to reunite the children with their parents. Later policy changes resulted in the detention of thousands of migrant children in federal custody. Given the high risk of permanent harm to an already vulnerable population, and the fact that this risk may continue into the near future, we present a symposium reviewing what nearly eight decades of scholarly research has taught us about the damaging impact of deprivation and separation from parents or primary caregivers. The symposium will review fundamental lessons from attachment theory as well as empirical studies that examine the psychosocial impact on children who experienced parental deprivation or separation.

Understanding the experiences of young children separated at the United States-Mexico border

Ashleigh I. Aviles, Nancy Hazen, & Deborah Jacobvitz

Trauma at the border: Psychological impact of parent-child separation

Deborah Jacobvitz

Self-reported attachment in young adults who were once left behind by caregiver migration

Amanda Venta, Cassandra Bailey, Tessa Long, Alfonso Mercado, & Cecilia Colunga

Separation without environmental deprivation: What don't we know? How can we know it?

Anne Rifkin-Graboi

Symposium Session 5.2

2:00 – 3:30 PM

Location: Regency B

Putting a Magnifying Lens on Attachment Transmission and Parental Sensitivity: A Multimethod Approach

Chair: Sheri Madigan & Marije Verhage

The intergenerational transmission of attachment has intrigued researchers across the globe since its discovery by Main and colleagues (1985). Research has focused on caregiver sensitivity as the primary mechanism through which attachment is transmitted to children, but meta-analytic evidence has indicated that caregiver sensitivity explains only 25% of the association (Van IJzendoorn, 1995; Verhage et al., 2016). Over twenty years of research has not brought us closer to resolving this ‘transmission gap’. The aim of this symposium is to take a closer look at each of the pathways of the mediation model of attachment transmission. This multi-method symposium comprises two papers that leverage the fine granularity of individual participant data meta-analysis in the dataset collated by the Collaboration on Attachment Transmission Synthesis (CATS), one traditional meta-analysis, and one large-sample single study. Collectively, these presentations will attempt to move the field forward to identifying additional avenues of research of attachment transmission.

Below the major classifications: A large-scale analysis of variation in adult attachment states of mind and parental sensitivity with IPD meta-analysis

R. M. Pasco Fearon, Marije L. Verhage, Marinus H. van IJzendoorn, Carlo Schuengel, Marian J. Bakermans-Kranenburg, Sheri Madigan, Glenn I. Roisman, Mirjam Oosterman, & Lee Raby

Parental sensitivity and mentalization as predictors of attachment quality: A meta-analysis

Sheri Madigan, Marije L. Verhage, Carlo Schuengel, Pasco Fearon, Marinus van IJzendoorn, Marian J. Bakermans-Kranenburg, & Mirjam Oosterman

How does risk background predict the intergenerational transmission of attachment? – Testing a moderated mediation model using individual participant data meta-analysis

Marije L. Verhage, Pasco Fearon, Carlo Schuengel, Marinus van IJzendoorn, Marian J. Bakermans-Kranenburg, Sheri Madigan, Glenn I. Roisman, & Mirjam Oosterman

The case of attachment non-transmission: Zooming in on the pathways through parental sensitivity

Anne Tharner, Marije L. Verhage, Mirjam Oosterman, & Carlo Schuengel

Symposium Session 5.3

2:00 – 3:30 PM

Location: Regency E

Odors and Social Relationships: Attachment Functions Across Species

Chair/Discussant: Pehr Granqvist

Just as a parent's physical presence is important in regulating a child's behavior, so too is a romantic partner's presence important for an adult's behavior in the context of a romantic attachment relationship. Such a presence can be represented in various ways and need to be physical. Previous studies have highlighted that showing a visual representation (picture) of the attachment figure suffices to regulate the attached individual's behaviors, as moderated by his/her attachment style. Compared with visual and tactile perception, however, the role of the olfactory sensory modality has remained grossly understudied, especially on adults.

In this symposium we highlight the unique sense of olfaction and how odors of an attachment figure can trigger the attachment behavioral system in different experimental settings, and in man and rats alike. A variety of measurements (psychological, physiological, neurological, behavioral) will be presented, all tied to the topic of olfactory cues and attachment functions.

Infant trauma with a caregiver: Acute neurobehavioral mechanisms and a role for amygdala dopamine

Maya Opendak

Is Beauty in the Nose of the Smeller?

Megan Williams

Exploratory Behavior in Virtual Reality, the Secure base function, and Body Odors

Anna Blomkvist

Benefits of Romantic Relationships: Can the Scent of a Romantic Partner Improve Sleep?

Marlise Hofer

Symposium Session 5.4

2:00 – 3:30 PM

Location: Regency F

Implementing Attachment-Based Intervention in Public Social Services: The Challenge of Knowledge Gaps and Translational Research

Chairs: George M. Tarabulsky & Chantal Cyr

The three papers proposed in this symposium address issues that concern the implementation of attachment-based knowledge and intervention strategies to applied settings who work in high-risk family environments. The first describes the implementation and evaluation of the Attachment-Videofeedback Intervention strategy (AVI) developed in Quebec in recent years (Moss et al., 2018) in 5 different child protection agencies. The second study addresses the topic of parental trauma-linked moderators of the efficiency of an attachment-based intervention. The third examines how attachment-based information may affect how child placement decisions are made. The discussion and question period will focus on the knowledge and training issues that continue to require further work and attention by researchers.

Implementation and effectiveness evaluation of the Attachment Video-feedback Intervention strategy in 5 child protection settings in Quebec

George M. Tarabulsky, Claire Baudry, Jessica Pearson, Tristan Milot, Chantal Cyr, Marc Provost & Jean-Pascal Lemelin

Improving sensitivity of maltreating parents with the Attachment Video-feedback Intervention (AVI): Parental childhood trauma as a moderator of treatment effects

Chantal Cyr, Sabine van der Asdonk & Lenneke Alink

Improving placement decisions in child protection cases by using information regarding parents' response to an attachment-based intervention: A vignette study

Sabine van der Asdonk, Sheila R. van Berkel, Whitney D. de Haan, Marinus H. van IJzendoorn, Carlo Schuengel & Lenneke R. A. Alink

Symposium Session 5.5

2:00 – 3:30 PM

Location: Oxford

Attachment & Cultural Diversity

Chair: Dave Pasalich

This symposium focuses on attachment experiences across cultures. The first paper explores the relationship between emotional regulation strategies and family environment, and focused on the notable differences in these processes between individuals in Mexico and the United States. The second paper is a qualitative, culturally informed analysis of parenting ethno-theories. The authors examined how mothers from different cultures (the Netherlands, Poland, and Turkey) describe distant and avoidant caregiving. Cross-cultural similarities and differences will be explored. The third paper explores maternal sensitivity (using the Ainsworth scales) in samples of rural Andean and Amazonian mothers and their infants. Future research directions in this growing area of study will be discussed.

Exploring the relationship between emotion regulation and family environment: A comparative study in Mexico and the United States

Julia Gallegos, Noah Berman, Manuel Ramirez III, Gladys Valdez & Jonathan Abramowitz

An emic approach to distant and avoidant parenting: Perceptions of mothers in Poland, Turkey, and the Netherlands

K. Lubiewska , K. Głogowska, N. Sumer & O. Aran

Maternal sensitivity in Rural Andean and Amazonian Peru

Katherine Fourment Sifuentes, Magaly Nóbrega, Gabriela Conde, Juan Nuñez del Prado & Judi Mesman

Symposium Session 5.6

2:00 – 3:30 PM

Location: Prince of Wales

Trauma, Adversity & Intervention

Chair: Pasco Fearon

This symposium focuses on caregiver factors that impact attachment outcomes in children. The first paper examines physical abuse risk in relation to maternal childhood attachment trauma and caregiving. The second paper explores young children's behaviours as a predictor for risk for maltreatment. The third paper explores the results of a meta-analysis of the association parents' adult attachment and adverse parenting practices/child abuse potential. The fourth paper examines how administering the Adult Attachment Interview (AAI) to parents prior to an emotion-focused intervention (Emotion-Focused Family Therapy; EFFT) and the impact on therapeutic process and treatment outcomes.

Assaults to the caregiving system: Contributions of maternal attachment trauma and responses to infant crying to abuse risk

Carol George

Stop it! Young children's Responses to Infant Crying and Caregiving Behavior Predict Maltreatment Risk

Gabriela Vargas

A meta-analytic study of the relationship between adult attachment and child maltreatment

Camilla Kin Ming Lo, Ko Ling Chan, & Patrick Ip

Clinical applications of the Adult Attachment Interview: Findings from a group-randomization study

Kristina Cordeiro, Laura Goldstein, Meghan Oliver, Mirisse Foroughe, & Robert T. Muller

Symposium Session 5.7

2:00 – 3:30 PM

Location: Balmoral

Attachment Continuity, Change and Intervention

Chair: Howard Steele

This symposium focuses on attachment continuity, change, and intervention. The first paper reports findings from a meta-analysis examining attachment stability at four developmental intervals (i.e., infancy, toddlerhood, preschool, and on school-entry) across early childhood (1-6 years), at four- and two-way levels of organization, and to undiscovered grey literature. The second paper assesses the effectiveness of Attachment and Biobehavioral Catch-up (ABC) on children's social-emotional well-being as it is moved from a research context to the community. The third paper examines the efficacy of a Therapeutic Nursery Program (TNP)—a relationship-centered, family-focused preventive-intervention program, which serves preschoolers (ages 3-5) with severe emotional and behavioral problems. The final paper examines the process of enhancing attachment security in parent-youth relationships through Connect Intervention using pre/post qualitative interviews and weekly audio-recorded diaries gathered from caregivers and youth. Overall implications for research and translation are discussed.

Attachment Continuity and Transition Across Early Childhood: A Meta-Analysis

Jessica E. Opie, Jennifer E. McIntosh, Timothy B. Esler, Carol George, Allan Schore, Emily J. Kothe, Evelyn S. Tan, Chris Greenwood & Craig A. Olsson

Disseminating Attachment and Biobehavioral Catch-up: Effects on Children's Social-Emotional Well-being

Galia Nissim, Allison Lazzaro, Steven Imrisek & Kristin Bernard

Changing developmental trajectory in high-risk families: The efficacy of an attachment-informed early-education program

Yair Ziv, Inbar Sofri, Kristen L. Capps Umphlet, Stephanie Olarte & Jimmy Venza

Storying shifts, and shifting stories: Documenting the process of enhancing attachment security in parent-youth relationships

Patti Ranahan, Katherine Pascuzzo & Marlene Moretti

Poster Session 5

2:00 – 3:30 PM

Location: Regency Foyer

Poster Number	Title	Presenting Author
P500	Maternal Compromised Care: Risk and Protective Factors Associated with Mothers' Representations of Caregiving	Rachel N. Acereto
P501	Does Clinician Reflective Functioning Predict MIO Treatment Outcomes? Findings from a Randomized Community-Based Clinical Trial	Nancy Suchman
P502	Attachment style and symptom reporting in young persons with concussion	Astrid Tuborgh
P503	Korean Children's Attachment Narratives: Association with Mother-Child Interactions and Family Drawings	Mikyoung Jin
P504	Child Personality Factors Moderate the Relation between Mothers' Parenting Style and Child Maltreatment in Kenya	Lilian Ayiro
P505	Exploring associations between maternal cumulative risks and children's attachment security	Brett Greenfield
P506	Disrupted Attachment and Displacement: Conceptualising Religious Psychopathology and Terrorism	Victor Counted
P507	When it is difficult to let go: Role of attachment and trauma in Hoarding Disorder	Kerryne Chia
P508	Childhood Trauma, Attachment, and The Extended Phenotype of Psychosis: An Investigation of the US population.	David Murphy

Poster Session 5 Continued

2:00 – 3:30 PM

Location: Regency Foyer

Poster Number	Title	Presenting Author
P509	Adverse childhood experiences and problematic technology use: The role of attachment and impulsivity	Amanda Howard
P510	Adult attachment disorganization as a mechanism linking childhood maltreatment with subclinical psychotic phenomena	Tamara Sheinbaum
P511	Shame Attributions among Mothers with Mild Intellectual Disability: Links to Traumatization and Child Attachment Representations	Mårten Hammarlund
P512	Relationship between Family Structure and Quality of Attachment to Parents & Peer Group in Adolescents	Ramin Zibaei

Symposium Session 6.1

4:00 – 5:30 PM

Location: Regency A

Supporting Parents with Attachment-Based Interventions and Social Support

Chair: Lavinia Barone

This symposium focuses on providing support to parents involved with attachment-based interventions. The first paper explores how parents with borderline personality disorder, play with their children and how they engage in attachment-based therapies. The second paper presents findings from a randomized controlled trial evaluating the effectiveness of the Parents as Teachers (PAT) program with participating at-risk families (e.g. high psychosocial stress, immigration, etc.) in Switzerland—specifically, examining the mediating role of maternal sensitivity for language development. The third paper explores the relationship between adult attachment anxiety and avoidance, two facets of social support (emotional and tangible), and depression and obsessive-compulsive symptoms in a sample of pregnant women from British Columbia, Canada. The final paper explores the use of an attachment-based parenting intervention (Video Feedback to Promote Positive Parenting) with mothers with personality disorder and their young infants (6-36 months). Results will be with preliminary recommendations for modifications to therapy and implications for practice.

Engaging parents with borderline personality disorder in attachment-based therapies: Results of a Mixed-Methods Study

Janet Lee-Evoy, Kristina Cordeiro, Jennifer Ip, Robert T. Muller, & Diane Philipp

Early interventions: The mediating role of maternal sensitivity for language development in at-risk families

Alex Neuhauser, Erich Ramseier, Simone Schaub, Susan C. A. Burkhardt, & Andrea Lanfranchi

Attachment, dimensions of social support and depressive and obsessive-compulsive symptoms in pregnancy

Fanie Collardeau, Nichole Fairbrother, Debra Torok, & Christina Frizzo

Boosting baby behaviour and bonding: A feasibility trial using video-feedback (VIPP) with mothers with personality disorder

Jane Iles, Kirsten Barnicot, Sarah Kalwarowsky, Mike Crawford, Paul Ramchandani, Eloise Stevens, & Jennie Parker

Symposium Session 6.2

4:00 – 5:30 PM

Location: Regency B

From Theory to Therapeutic Action: Advancements in the Training and Dissemination of Attachment-Based Interventions

Chair: Kelsey Armusewicz

Discussant: Inga Blom

With the rapid dissemination of evidenced-based psychotherapies, there is increasing interest in clinical training and monitoring fidelity. In attachment-based interventions, the need to facilitate attachment security, reflective functioning, and responsive caregiving is of utmost importance. Training clinicians, and ensuring their interventions are in line with these goals, is fundamental to positive outcomes for families.

This symposium will discuss approaches to training and fidelity in three interventions, Mothering from the Inside Out (MIO), the Group Attachment Based Intervention (GABI), and Psychoanalytic Parent-Infant Psychotherapy (PIP). Through the lens of each of these interventions, there will be a discussion of training protocols and supervision, including the use of video and research measures to empirically study training outcomes. Implications for future training and intervention research will be discussed. The presentation will conclude with a discussion of applying such measures across a range of attachment-based interventions.

Innovations in the assessment of training in parent-child interventions

Jordan Bate, Howard Steele, Anne Murphy, Tessa Baradon, & Miriam Steele

Can addiction counselors be trained to deliver Mothering from the Inside Out with sufficient treatment fidelity and clinical RF?

Nancy E. Suchman, Cindy DeCoste & Jessica Borelli

REARING Coding System (RCS): Validation of a competence coding system for Group Attachment Based Intervention (GABI©) Clinicians

Kelsey Armusewicz, Jordan Bate, Lorena Lopez, Miriam Steele, Howard Steele, Brooke Allman & Anne Murphy

Symposium Session 6.3

4:00 – 5:30 PM

Location: Oxford

Neurobiological Processes, Parenting & Attachment

Chair: Stefania V. Vacaru

This symposium focuses on neurobiological processes, parenting, and attachment. The first paper investigates whether the intrinsic affiliation motivation of children characterized by either resistant or avoidant insecure attachment tendencies modulate facial mimicry (FM) responses during early development (Study 1: 3-year-olds), and whether children selectively employ FM as means to attain affiliations—based on their attachment tendencies—during social interactions involving social exclusion (Study 2: 5-year-olds). The second paper examined the brain systems involved in maternal responses to infant cues and its relation with maternal attachment and sensitive behavior. The third paper presents neurobiological evidence that distinct neural pathways in the parent's brain in response to the other co-parent and the endocrine systems and behavioral mechanisms related to those, suggesting that they serve an important regulatory role in children's development. Research and clinical implications are discussed.

The Role of Attachment Relationships in the Modulation of Facial Mimicry during Early Development

Stefania V. Vacaru, Johanna E. van Schaik, Erik de Water & Sabine Hunnius

When Mommy gets me: Mothers' attachment and sensitivity predict brain responses to infant cues

Joana L. Gonçalves, Marina Fuertes, Fernando Ferreira-Santos & Pedro Lopes-dos-Santos

The Human Coparental Bond Implicates Distinct Corticostriatal Pathways: Longitudinal Impact on Family Formation and Child Well-Being

Eyal Abraham

Symposium Session 6.4

4:00 – 5:30 PM

Location: Balmoral

Development and Validation of Measures Assessing Attachment

Chair: Marian Bakermans-Kranenburg

This symposium focuses on the development and validation of measures assessing attachment. The first paper presents findings validating the Attachment Focused Coding System (AFCS) for a German sample providing an empirically based coding system for attachment classifications using the AFCS. The second paper presents findings from a longitudinal study examining a German-language version of the Child Attachment Interview (CAI). The third paper addresses a gap in knowledge by distilling the practice elements that are common across effective attachment-based interventions, and matching these practice element profiles to various population characteristics. The final paper provides the first evaluation of a novel and brief method of coding adolescents' 3-minute speech samples regarding their thoughts and feelings about their parent, the Family Affective Attitudes Rating Scale (FAARS). Results are discussed in relation to clinical utility and theory.

Attachment in early childhood: Validation of the Attachment-Focused Coding System (AFCS) in a German sample

Lena-Mareike Rode & Christel Salewski

The Child Attachment Interview (CAI): A psychometric longitudinal validation study in a German sample

Jörn Meyer & Stefan Stürmer

The development of a coding system to examine the effective elements of attachment-based interventions

Ahmed Riaz Mohamed, Paula Sterkenburg, Esmé van Rensburg & Carlo Schuengel

Observational assessment of adolescents' relational schemas

Sarah McKenna, Dave Pasalich, Richard O'Kearney & Allison Hassel

Symposium Session 6.5

4:00 – 5:30 PM

Location: Regency E

Understanding Attachment in Children at Risk

Chair: Pasco Fearon

This symposium highlights the differences in attachment representations among children at risk for psychopathology. Generally, children with more psychopathology tend to report less attachment security. For example, victims of sexual abuse expect less emotional support from their caregivers and report greater attachment insecurity. Children with autism who are higher functioning report greater security in their relationships and adolescents with binge-eating displayed greater preoccupation than their counterparts.

A fine-grained analysis of the narratives of sexually abused preschoolers
Rachel Langevin, Louise Cossette & Martine Hébert

Attachment of children with Autism Spectrum Disorder to their fathers
David Oppenheim, Tirtsas Joels & Nina Koren-Karie

Attachment representations in community girls at risk of Binge Eating Disorder
Cecilia Serena Pace & Stefania Muzi

Attachment patterns in a sample of SA children at risk in middle childhood
Renate Gericke & Carol Long

Symposium Session 6.6

4:00 – 5:30 PM

Location: Prince of Wales

Social Media & Attachment in Adolescents and Young Adults

Chair: Dave Pasalich

This symposium explores social media and attachment in adolescence and young adulthood. The first paper applies an attachment theory framework to understanding university students' relationships with their smartphones. The second paper examines whether adolescent network composition is related to patterns of social behavior in online and offline relationships. The third paper adopts an explorative approach to test main dimensions of adult attachment style as the predictor variable of Instagram use. Implications of social media usage and relationship patterns online and offline are discussed.

Beyond Interpersonal Attachment: An Examination of University Students' Relationships with their Smartphones within an Attachment Theory Framework

Natasha Parent, Takara Bond & Jennifer Shapka

Adolescent attachment network and online/offline relationship patterns

Qijuan Fang, Irene Harper, Musheera Anis Abdellatif, Etienne Z. Gnimpieba & Harry Freeman

Connections and bonds: Predicting Instagram behaviors from attachment components

I. Cataldo, S. Loo, B. Lepri & G. Esposito

Poster Session 6

4:00 – 5:30 PM

Location: Regency Foyer

Poster Number	Title	Presenting Author
P600	How can Early Childhood Intervention professionals improve the attachment security of children with a disability or developmental delay?	Stacey Alexander
P601	Innovative Methods to Rapidly Test and Mobilize Effective Early Childhood Interventions: A Realist Synthesis	Lubna Anis
P602	Feasibility of emotionally focused family therapy for adolescents affected by somatization in a tertiary care setting: Protocol	Amrit K. Dhariwal
P603	Childhood toxic stress and immune cell gene expression: Testing the protective effects of the ATTACH Parenting Intervention	Kharah M. Ross
P604	Effectiveness of an Attachment-Based Intervention for the Assessment of Parenting Capacity in Maltreating Families: An RCT	Sabine van der Asdonk
P605	Maternal Experiences of Childhood Emotional Abuse and Relations with Toddler Emotion Dysregulation	Ashleigh I. Aviles
P606	ACEs in Motion: Epistemic Trust and Trauma Disclosure in CARE Groups	Anna Kilbride
P607	Training Undergraduate Researchers to Administer a Brief Mentalization - and Attachment - based Intervention	Kajung Hong

Poster Session 6 Continued

4:00 – 5:30 PM

Location: Regency Foyer

Poster Number	Title	Presenting Author
P608	Filicides Psychopaths: Neurobiological and psychiatry assessment	Ana Calzada-Reyes
P609	The Adaptation Study of the Client Attachment to Therapist Scale	Fatma Mahperi Uluoyol Hekimoğlu
P610	Engaging Families in the Group Attachment Based Intervention (GABI): Understanding Factors Associated with Treatment Retention.	Jeana DeMairo
P611	Brief Mentalizing Intervention Increases Parental Reflective Functioning and Decreases Children's Internalizing Difficulties	Tina Adkins
P612	Standardizing Measurement and Dose-Response of Peripheral Oxytocin Following Intranasal Delivery	Jamie L. Scholl
P613	Establishment of convergent validity for the AMBIANCE-brief: An observational assessment tool of disrupted caregiving	Rachel Eirich

The Society for Emotion and Attachment Studies welcomes you to the 9th International Attachment Conference!

SEAS is devoted to the dissemination and use of reliable and valid attachment measures for the advancement of research and clinical work aimed at understanding and promoting security in children, families, and society. The prevention of child abuse and respect for diversity in family forms are vital to the SEAS mission.

SEAS MEMBER BENEFITS:

- Gratis copies of Attachment & Human Development
- Digital access to every year's journal contents
- Discount on SEAS-sponsored events (SRCD pre-conference workshops, IACs, and events sponsored by partner organizations)

Find out more about joining SEAS, and stay up to date on trainings and other opportunities, at:

www.SEASinternational.org

SEAS General Meeting

Saturday, July 20th 2019

Time: 12:30 – 2:00 PM

Location: Prince of Wales

We welcome all SEAS members to join us for the annual SEAS General Meeting.

We hope you enjoy IAC 2019 and look out for conference photos on the SEAS website by August.

Convention Level (Third Floor)

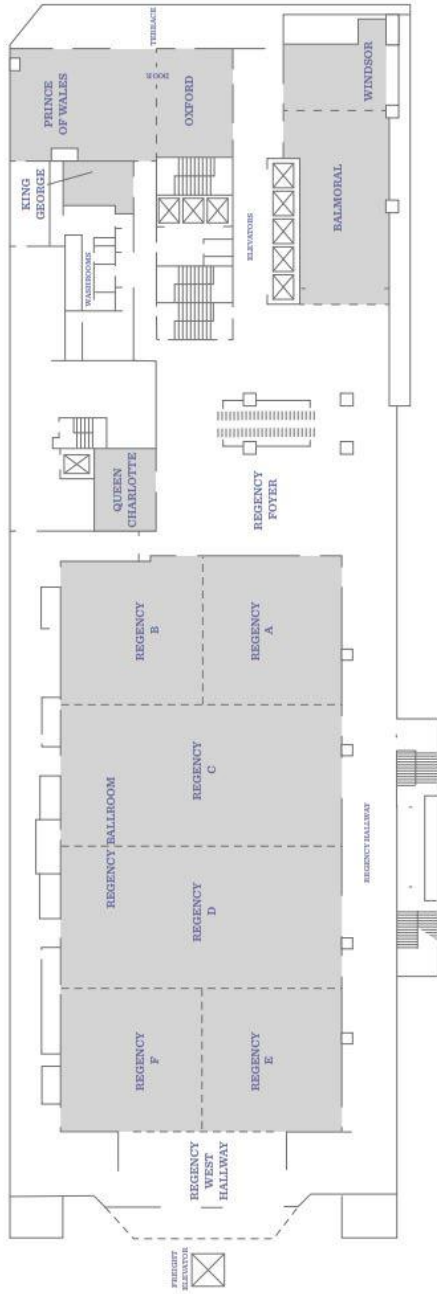

HYATT REGENCY VANCOUVER

Food & Shopping

Starbucks (Main floor, Hyatt Regency)

49th Parallel Café & Lucky's Doughnuts (689 Thurlow St, Vancouver, BC V6E 4M3)

Thierry (1059 Alberni St, Vancouver, BC V6E 1A1)

Caffè Artigiano (666 Burrard St #150, Vancouver, BC V6C 3L2)

JJ Bean Coffee Roasters (1188 Alberni St, Vancouver, BC V6E 1A5)

Cartems Donuts (534 W Pender St, Vancouver, BC V6B 1V3)

La Taqueria Pinche Taco Shop (586 Hornby St, Vancouver, BC V6C 3B6)

Cactus Club Cafe Bentall 5 (588 Burrard St, Vancouver, BC V6C 0A8)

Black+Blue Steakhouse (1032 Alberni St, Vancouver, BC V6E 1A3)

Meat & Bread (1033 W Pender St, Vancouver, BC V6E 2M6)

Stephos Greek Taverna (2 locations: Robson and Davies)

Phnom Penh Chinatown (244 E Georgia St, Vancouver, BC V6A 1Z7)

Robba Da Matti Yaletown (1127 Mainland St, Vancouver, BC V6B 5P2)

Ebisu on Robson (827 Bute St, Vancouver, BC V6E 3Y4)

Basils Pasta Bar (1602 Yew St, Vancouver, BC V6K 3E7)

Vegan/Vegetarian Friendly

Chickpea Food Truck (884 W Cordova St, Vancouver, BC V6C 3N8)

MeET in Gastown (12 Water St, Vancouver, BC V6B 4K7)

Indigo Age Café (436 Richards St, Vancouver, BC V6B 2Z4)

CF Pacific Centre & Food Court (701 W Georgia St, Vancouver, BC V7Y 1G5)
<https://www.cfshops.com/pacific-centre/dining-entertainment.html>

Royal Centre Mall & Food Court (1055 W Georgia St, Vancouver, BC V0N 1V0)
<http://royalcentre.com/retail-directory/>

For more great options, search for 'restaurants on Robson St., Vancouver' or 'restaurants in Gastown, Vancouver'.

For shopping, check out Pacific Centre Mall or search 'shopping in downtown Vancouver.'

Directions from Vancouver International Airport to Hyatt Regency Vancouver by Car

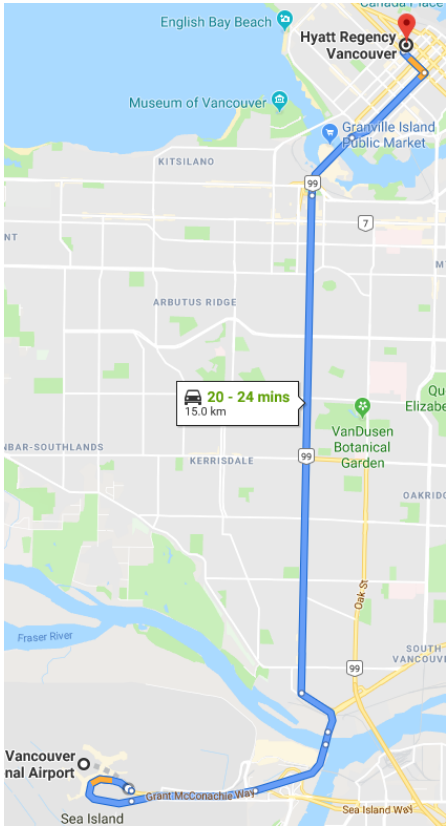

Vancouver International Airport

3211 Grant McConachie Way, Richmond, BC V7B 0A4

- Take Grant McConachie Way E to Granville St in Vancouver
9 min (5.3 km)
- Follow Granville St and BC-99 N to Burrard St
20 min (9.6 km)
- Turn right onto Burrard St
📍 Destination will be on the left
29 s (82 m)

Hyatt Regency Vancouver

655 Burrard St, Vancouver, BC V6C 2R7

Directions from Vancouver International Airport to Hyatt Regency Vancouver by Transit (Skytrain)

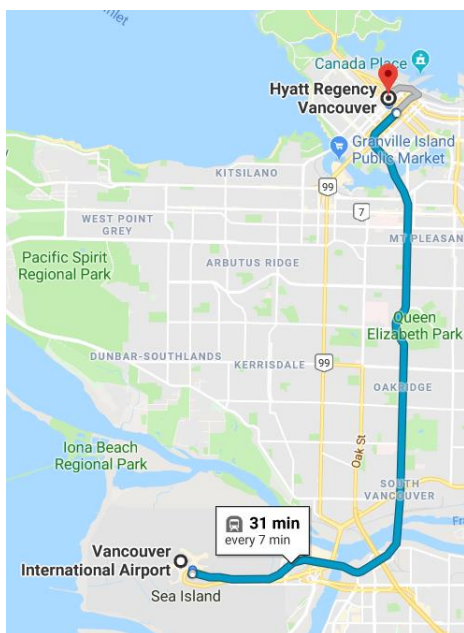

- Vancouver International Airport
3211 Grant McConachie Way, Richmond, BC V7B 0A4

- Walk
 - ▼ About 2 min , 130 m

- YVR-Airport Station

- Canada Line** Canada Line to Waterfront
 - ▼ 24 min (11 stops) - Platform 2

- Vancouver City Centre Station

- Walk
 - ▼ About 5 min , 350 m

- Hyatt Regency Vancouver
655 Burrard St, Vancouver, BC V6C 2R7

Directions from Hyatt Regency to SFU Harbour Centre by Walking

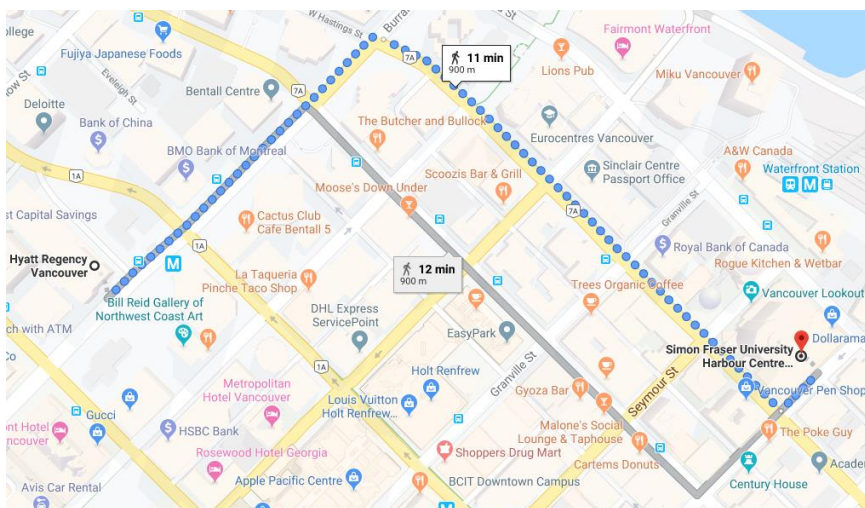

For more detailed navigation, please enter addresses directly into GoogleMaps.